

**JAY FLIGHT**

*family favorite*

DESTINED FOR FUN.





america's family  
**FAVORITE**



A FEW OF THE MANY REASONS JAY FLIGHT CONTINUES TO BE THE TOP-SELLING TRAVEL TRAILER

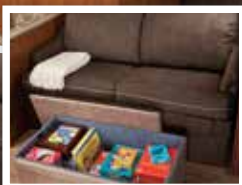

**FLEXIBLE FOR FAMILIES**

Making the most of space, the standard Flex Dinette features pull-out seating, comfortable ottoman and roomy storage, making this U-dinette a family must.



**AMPLE STORAGE**

There's no shortage of durable storage thanks to Amish-crafted cabinetry and a 6.3 cu. ft. double-door refrigerator.

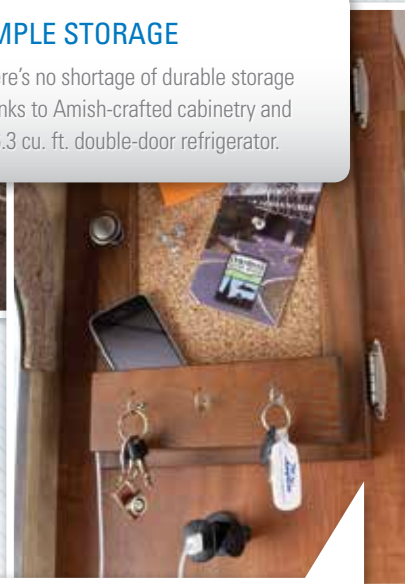

**COMMAND YOUR RV**

The command center hides all of your controls behind a convenient message board with 12V cell phone charger outlet.



**YOU WANT PEACE OF MIND**

That's why we offer our exclusive 2-year Co-Pilot Warranty, the industry's best and most comprehensive warranty program.





# america's favorite **DESTINATION**

AND ALL THE MANY REASONS YOU'LL WANT TO LENGTHEN YOUR NEXT FAMILY GETAWAY

## FULL-FEATURED KITCHEN

You'll forget you're cooking in an RV thanks to our destination models' 18 cu. ft. residential-style refrigerator with ice maker, large 60/40 deep-bowl sink with high-rise faucet and stunning Glazed Concord Cherry cabinetry.



## OPTIONAL FIREPLACE

Relax in front of a LedgeStone electric fireplace with brick facade and large HDTV.



## RESIDENTIAL-STYLE ATRIUM

A residential-style atrium, 60" sliding patio door and detachable hitch provide home-like exterior touches on Jay Flight's destination models.



## HIDE-A-BED SOFA WITH OTTOMAN\*

Perfect for family members or overnight guests.

\*Optional on DST.

## WITH YOUR PURCHASE

Every Jayco RV undergoes rigorous quality control testing before it leaves the factory, so you can be confident your new Jayco will continue to provide the ultimate in reliability for years to come.

For a copy of our 2-year Co-Pilot limited warranty with full terms and conditions, ask your local Jayco dealer.



TO LEARN MORE ABOUT OUR QUALITY CONTROL TESTING, SCAN HERE WITH YOUR SMARTPHONE.





JAY FLIGHT TRAVEL TRAILERS



america's *family favorite*

Spacious slideouts, well-designed living areas, 18 different floorplans and an endless list of family-friendly features make the Jay Flight travel trailer the perfect fit for any family. And with 75-plus gallons of fresh water, we're certain we can keep up with your family demands, too.





JAY FLIGHT 32TSBH | HAZELNUT



JAY FLIGHT 25RKS | SANDALWOOD



JAY FLIGHT 32TSBH | HAZELNUT

## DINNER TIME

Jayco has dinner covered with a 3-burner gas range, a residential-style sink and microwave oven with carousel.

## READY TO TOW

Built for families on the go, Jay Flight is packed with more standard towing features, like E-Z Lube axles for easy maintenance and an aerodynamic curved front profile for better gas economy. Once you get there, optional electric stabilizer jacks make setup a breeze.



JAY FLIGHT 32TSBH | HAZELNUT

**OPTION A**



**OPTION B**

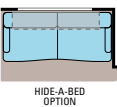

**OPTION C**



**OPTION D**



**OPTION E**

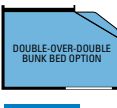

**OPTION F**

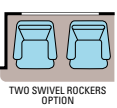

**OPTION G**

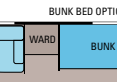

**OPTION H**

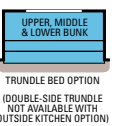

**OPTION I**

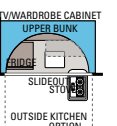

**OPTION J**



**OPTION K**

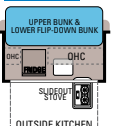

**OPTION L**

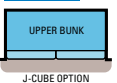

**OPTION M**

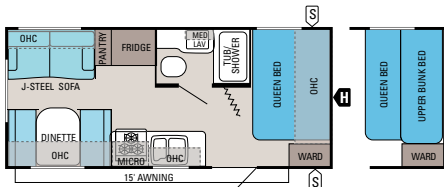

**JAY FLIGHT | 19RD**

Ext. Length: 23' 1" Ext. Height: 128" Unloaded Wt. (lbs.): 3,915 Sleeps: 4-7

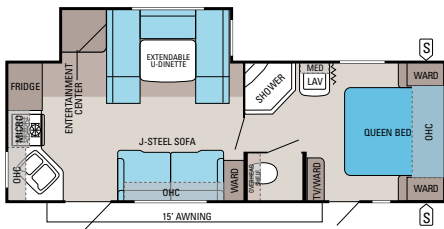

**JAY FLIGHT | 25RKS**

Ext. Length: 28' 8" Ext. Height: 135" Unloaded Wt. (lbs.): 5,865 Sleeps: 4-6

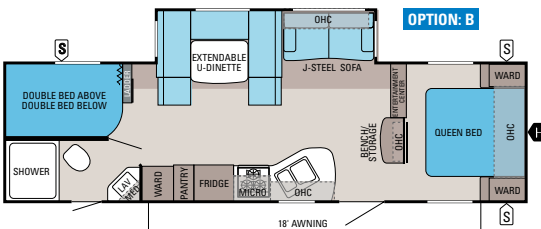

**JAY FLIGHT | 28BHB**

Ext. Length: 33' 3" Ext. Height: 134" Unloaded Wt. (lbs.): 6,430 Sleeps: 8-10

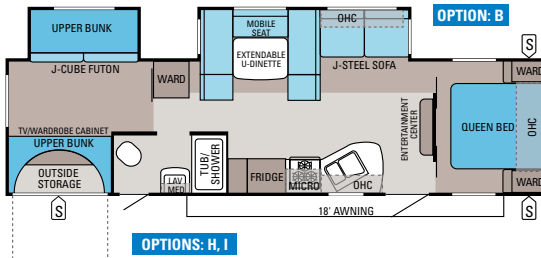

**JAY FLIGHT | 32BHDS**

Ext. Length: 35' 6" Ext. Height: 134" Unloaded Wt. (lbs.): 7,445 Sleeps: 8-10

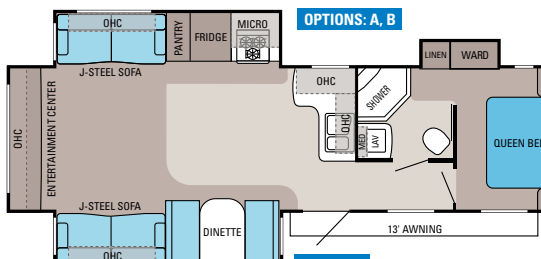

**JAY FLIGHT | 33RLDS**

Ext. Length: 35' 5" Ext. Height: 134" Unloaded Wt. (lbs.): 7,825 Sleeps: 3-8

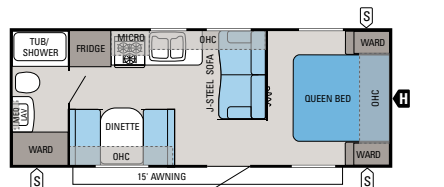

**JAY FLIGHT | 22FB**

Ext. Length: 26' 5" Ext. Height: 127" Unloaded Wt. (lbs.): 4,150 Sleeps: 4-6

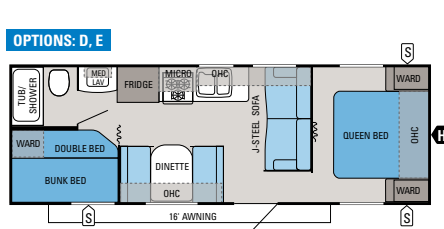

**JAY FLIGHT | 26BH**

Ext. Length: 29' 1" Ext. Height: 127" Unloaded Wt. (lbs.): 4,570 Sleeps: 7-9

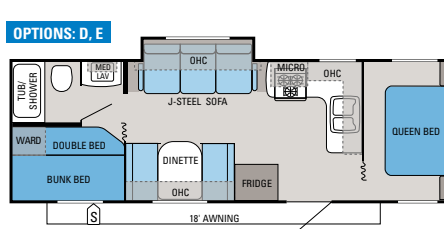

**JAY FLIGHT | 28BHS**

Ext. Length: 30' 6" Ext. Height: 127" Unloaded Wt. (lbs.): 5,045 Sleeps: 7-9

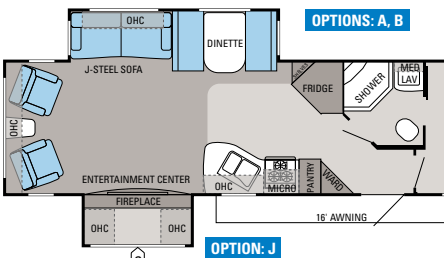

**JAY FLIGHT | 32RLDS**

Ext. Length: 35' 6" Ext. Height: 134" Unloaded Wt. (lbs.): 7,520 Sleeps: 3-6

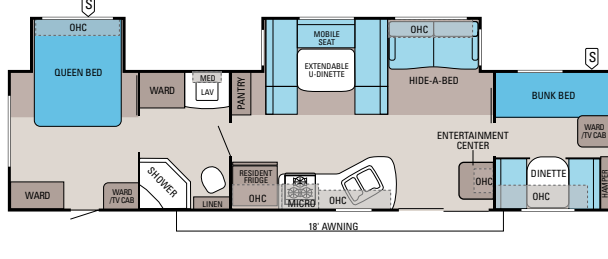

**JAY FLIGHT | 36BHDS**

Ext. Length: 38' Ext. Height: 134" Unloaded Wt. (lbs.): 7,910 Sleeps: 8-10

- S OUTSIDE STORAGE      MICRO    MICROWAVE
- H TRAILER HITCH            OHC     OVERHEAD CABINETS
- LAV    BATHROOM SINK        FRIDGE    REFRIGERATOR
- WARD    WARDROBE



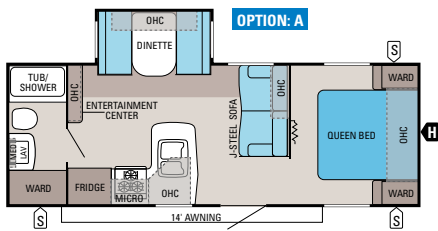

### JAY FLIGHT | 24FBS

Ext. Length: 27' Ext. Height: 134" Unloaded Wt. (lbs.): 4,870 Sleeps: 3-6

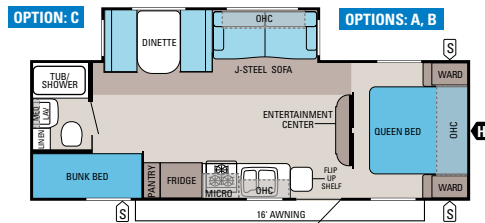

### JAY FLIGHT | 25BHS

Ext. Length: 28' 11" Ext. Height: 134" Unloaded Wt. (lbs.): 5,770 Sleeps: 6-8

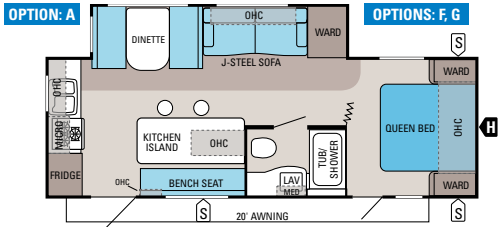

### JAY FLIGHT | 26RKS

Ext. Length: 28' 5" Ext. Height: 134" Unloaded Wt. (lbs.): 5,970 Sleeps: 3-6

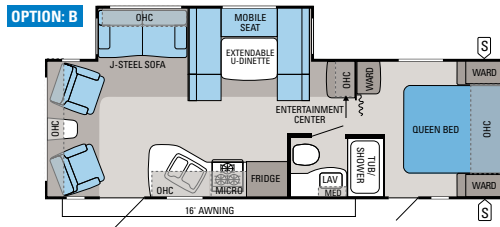

### JAY FLIGHT | 26RLS

Ext. Length: 30' Ext. Height: 134" Unloaded Wt. (lbs.): 6,005 Sleeps: 4-6

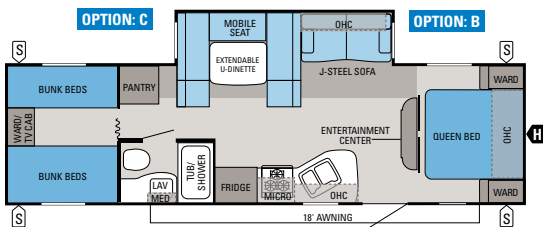

### JAY FLIGHT | 29QBH

Ext. Length: 33' 3" Ext. Height: 134" Unloaded Wt. (lbs.): 6,575 Sleeps: 9-10

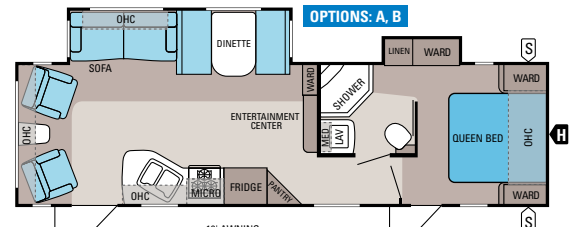

### JAY FLIGHT | 29RLDS

Ext. Length: 33' 5" Ext. Height: 134" Unloaded Wt. (lbs.): 6,990 Sleeps: 3-6

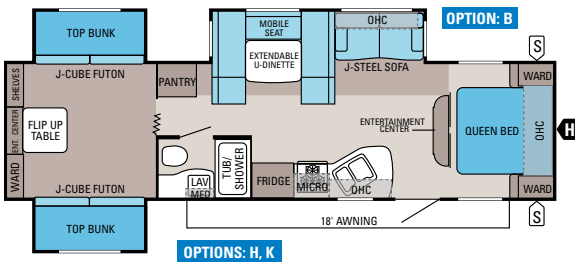

### JAY FLIGHT | 32TSBH

Ext. Length: 35' 6" Ext. Height: 134" Unloaded Wt. (lbs.): 7,775 Sleeps: 11-12

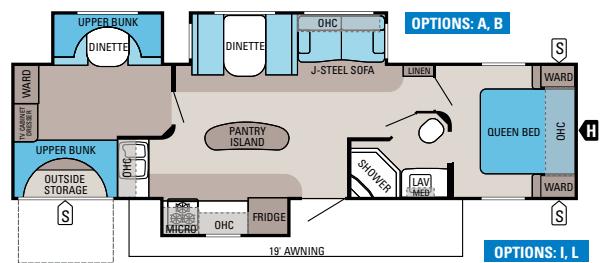

### JAY FLIGHT | 33BHTS

Ext. Length: 36' 11" Ext. Height: 134" Unloaded Wt. (lbs.): 7,955 Sleeps: 6-10

## SPECIFICATIONS

FLOORPLAN	EXTERIOR LENGTH	EXTERIOR WIDTH	EXTERIOR HEIGHT (WITH A/C)	INTERIOR HEIGHT	UNLOADED VEHICLE WEIGHT (LBS.)	DRY HITCH WEIGHT (LBS.)	GROSS VEHICLE WEIGHT RATING (LBS.)	CARGO CARRYING CAPACITY (LBS.)	FRESH WATER CAPACITY (GAL.) (WITH WATER HEATER)	GRAY WASTEWATER CAPACITY (GAL.)	TOILET/BLACK WASTEWATER CAPACITY (GAL.)
19RD	23' 1"	96"	128"	81"	3,915	465	6,200	2,285	90	32.5	32.5
22FB	26' 5"	96"	127"	81"	4,150	565	6,500	2,350	90	32.5	32.5
24FBS	27'	96"	134"	81"	4,870	465	7,500	2,630	86	32.5	32.5
25BHS	28' 11"	96"	134"	81"	5,770	755	8,180	2,410	86	32.5	32.5
25RKS	28' 8"	96"	135"	81"	5,865	790	8,400	2,535	86	65	32.5
26BH	29' 1"	96"	127"	81"	4,570	560	7,500	2,930	90	32.5	32.5
26RKS	28' 5"	96"	134"	81"	5,970	790	8,400	2,430	86	65	32.5
26RLS	30'	96"	134"	81"	6,005	820	8,500	2,495	86	32.5	32.5
28BHBE	33' 3"	96"	134"	81"	6,430	665	9,250	2,820	86	32.5	32.5
28BHS	30' 6"	96"	127"	81"	5,045	690	7,500	2,455	90	32.5	32.5
29QBH	33' 3"	96"	134"	81"	6,575	870	9,250	2,675	86	32.5	32.5
29RLDS	33' 5"	96"	134"	81"	6,990	955	9,500	2,510	86	65	32.5
32BHDS	35' 6"	96"	134"	81"	7,445	1,015	9,975	2,530	86	32.5	32.5
32RLDS	35' 6"	96"	134"	81"	7,520	875	10,250	2,830	86	32.5	32.5
32TSBH	35' 6"	96"	134"	81"	7,775	815	10,500	2,725	86	32.5	32.5
33BHTS	36' 11"	96"	134"	81"	7,955	880	10,500	2,545	86	65	32.5
33RLDS	35' 5"	96"	134"	81"	7,825	1,070	10,300	2,475	86	32.5	32.5
36BHDS	38'	96"	134"	81"	7,910	940	10,500	2,590	90	32.5	32.5

The weights of certain options and/or option packages are not included in the UWW listed above.



JAY FLIGHT BUNGALOW 40FKS | DRIFTWOOD



JAY FLIGHT DST 40BHTS | HAZELNUT



JAY FLIGHT DST 40BHTS | HAZELNUT



JAY FLIGHT DST 40BHTS | HAZELNUT

JAY FLIGHT DESTINATION TRAILERS



JAY FLIGHT DST

JAY FLIGHT BUNGALOW

america's favorite *destination*

Stay awhile in the Jay Flight destination trailers. Thanks to spacious floorplans, taller ceilings and a host of residential amenities, like standard ceiling fans and optional king-sized beds, your next camping destination is certain to be a good one.



## JAY FLIGHT DST FLOORPLANS

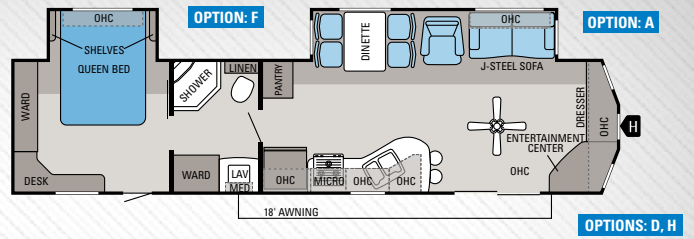
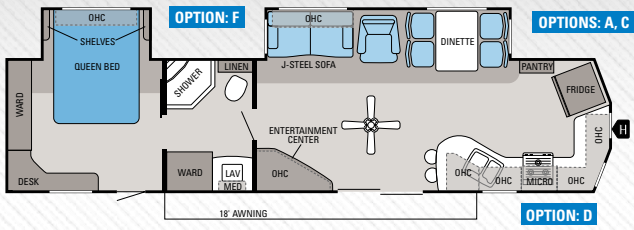

### JAY FLIGHT DST | 38FKDS

Ext. Length: 38' 11" Ext. Height: 146" Unloaded Weight (lbs.): 8,895 Sleeps: 3-4

### JAY FLIGHT DST | 38FLDS

Ext. Length: 38' 11" Ext. Height: 146" Unloaded Weight (lbs.): 8,730 Sleeps: 3-4

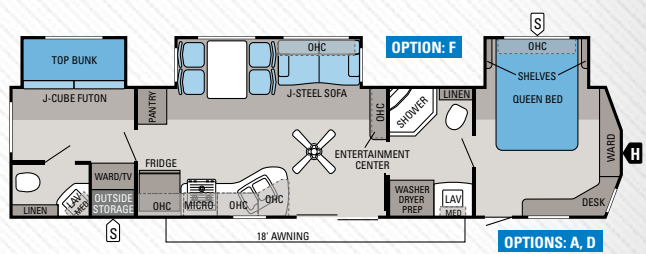
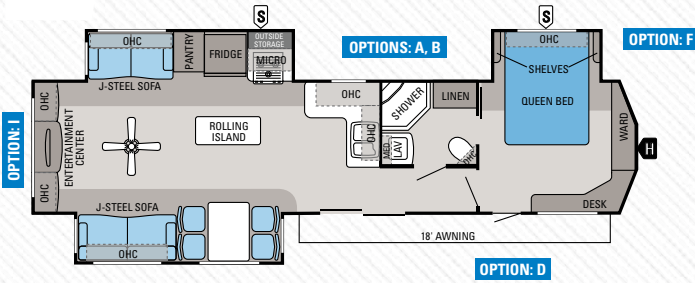

### JAY FLIGHT DST | 38RLTS

Ext. Length: 38' 11" Ext. Height: 147" Unloaded Weight (lbs.): 9,595 Sleeps: 3-6

### JAY FLIGHT DST | 40BHTS

Ext. Length: 40' 11" Ext. Height: 147" Unloaded Weight (lbs.): 9,325 Sleeps: 5-7

## JAY FLIGHT BUNGALOW FLOORPLANS

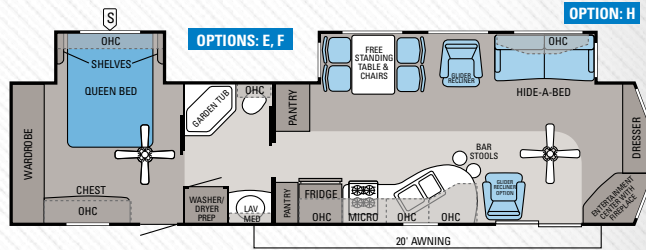
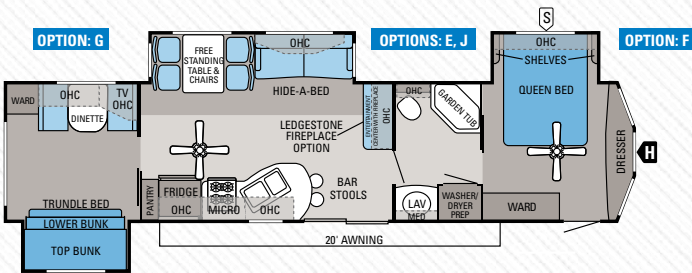

### JAY FLIGHT BUNGALOW | 40BHS

Ext. Length: 40' 11" Ext. Height: 152" Unloaded Weight (lbs.): 10,535 Sleeps: 8-10

### JAY FLIGHT BUNGALOW | 40FER

Ext. Length: 40' 11" Ext. Height: 152" Unloaded Weight (lbs.): 10,365 Sleeps: 4-6

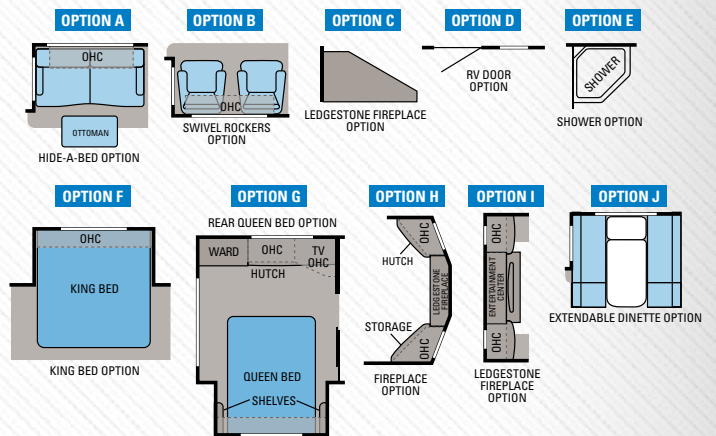
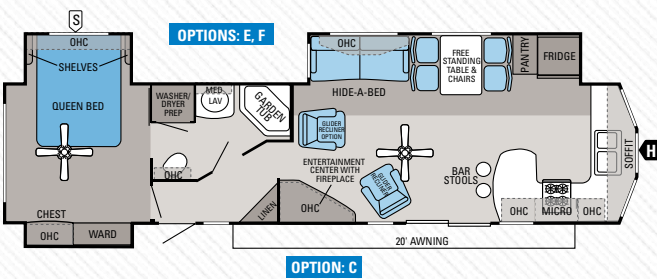

### JAY FLIGHT BUNGALOW | 40FKS

Ext. Length: 40' 11" Ext. Height: 152" Unloaded Weight (lbs.): 10,450 Sleeps: 4-6

## SPECIFICATIONS

FLOORPLAN	EXTERIOR LENGTH	EXTERIOR WIDTH	EXTERIOR HEIGHT (WITH A/C)	INTERIOR HEIGHT	UNLOADED VEHICLE WEIGHT (LBS.)	DRY HITCH WEIGHT (LBS.)	GROSS VEHICLE WEIGHT RATING (LBS.)	CARGO CARRYING CAPACITY (LBS.)	FRESH WATER CAPACITY (GAL.) (WITH WATER HEATER)	GRAY WASTEWATER CAPACITY (GAL.)	TOILET/BLACK WASTEWATER CAPACITY (GAL.)
JAY FLIGHT DST	38FKDS	38' 11"	96"	146"	90"	8,895	1,325	11,500	2,605	50	39
	38FLDS	38' 11"	96"	146"	90"	8,730	1,195	11,500	2,770	50	78
	38RLTS	38' 11"	96"	147"	90"	9,595	1,375	12,000	2,405	50	39
	40BHTS	40' 11"	96"	147"	90"	9,325	1,420	12,000	2,675	50	78
JAY FLIGHT BUNGALOW	40BHS	40' 11"	102"	152"	96"	10,535	1,550	12,500	1,965	50	32.5
	40FER	40' 11"	102"	152"	96"	10,365	1,645	12,500	2,135	48	32.5
	40FKS	40' 11"	102"	152"	96"	10,450	1,565	12,500	2,050	48	32.5

The weights of certain options and/or option packages are not included in the UWW listed above.



# CONSTRUCTION *and craftsmanship*

At Jayco, we've built a reputation for superior construction and quality craftsmanship. We pride ourselves on always using top-quality materials and innovative manufacturing techniques. That commitment has led to our latest construction advancement, the all-new exclusive Magnum Roof System, 50 percent stronger than other roofs in the industry, built to outlast everything but your memories.



## OUR NEW ROOF FEATURES ...

- 1 1 1/2" crowned wood trusses: Uses 2"x 2" vertical studs to maximize load capacity, while oversized nail plates provide a tighter design
- 2 3/8" roof decking, screwed down at every seam: More durable than typical stapled construction, provides fully walkable roof
- 3 Residential attic-style insulation: Maintains interior temperatures while allowing for room to run wiring, reducing risky electrical shorts
- 4 One-piece, sidewall-wrapped Alpha Ply material: Provides leak protection



## WALL CONSTRUCTION

- 5 2" x 2" wooden studs: Creates Jay Flight's long-lasting framework
- 6 Hand-tucked and glued fiberglass insulation (R-7): Prevents insulation from sagging over time (vs. blanket-insulation technique), while helping increase insulation value near studs
- 7 Extra-wide corner seals: Prevents leaks on the corner molds, baggage/entrance doors, window seals

## FLOOR CONSTRUCTION

- 8 5/8" tongue-and-groove plywood deck on 2" x 3" wooden floor joists: Moisture resistant, plywood holds up to the elements
- 9 Fiberglass insulation (R-7): Maintains interior temperatures
- 10 Full-width outriggers: Supports wall weight with no more than 4-foot spacing (vs. 8-foot spacing) and wall-to-wall, full-width design

## FEATURES

- 11 Galvanized-steel wheel wells: Reduces heat loss through floor; prevents floor damage in case of a blown tire
- 12 WaterWorks system: Boasts 75-plus gallons of fresh water (n/a destination models)
- 13 Innovative, aerodynamic front profile: Eliminates angled profile, increasing towability (n/a destination models)

## INTERIOR DÉCORS

### PLATINUM



### HAZELNUT



### SANDALWOOD



### DRIFTWOOD

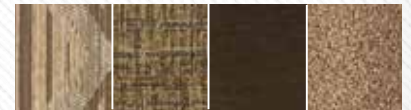

### WOOD



**eCO advantage™** [www.jayco.com/ecoadvantage](http://www.jayco.com/ecoadvantage)

THE JAYCO ECOADVANTAGE IS OUR COMPANY'S COMMITMENT TO PROTECTING THE ENVIRONMENT. Scan this QR code with your smartphone to watch a video about our efforts and the impact we're having on our world.



**STANDARD EXTERIOR EQUIPMENT**

I-Class cambered structural-steel I-beam frame with fully integrated A-frame
Magnum truss roof system with one-piece seamless Alpha Ply
5/8" tongue-and-groove plywood floor decking
Two-sided reflective foil insulation in flush-floor slideout floors
Electric slideouts with enclosed gear system (slide models)
30" x 72" main entrance door with step light
Exterior-marine grade speakers (2)
G20 dark-tint windows
Radial tires with galvanized-steel, impact-resistant wheel wells
E-Z Lube axles
Aerodynamic, rounded front profile with front diamond plate
Black tank flush sprayer
30-amp power service
WaterWorks system with 75+ gallon freshwater capacity and durable, winterized Tuff Pex water lines
Stabilizer jacks with sand pads (4)

**STANDARD INTERIOR EQUIPMENT**

Screwed-and-glued Glazed Concord Cherry cabinetry
Ball bearing drawer guides, 75-lb. capacity, full-drawer extension
Large 60/40 acrylic kitchen sink with high-rise faucet
6-gal. gas/electric DSI Atwood water heater
3-burner range with 9,000-BTU SuperBurner and piezo igniter
6.3 cu. ft. Norcold double-door refrigerator
Atwood auto ignition furnace with wall thermostat
Cable/satellite prep
Plywood bed, dinette and bunk bases
J-Steel jack-knife sofa
Diamondflor vinyl flooring
Residential-grade carpet with padding
Porcelain stool with foot flush
300-lb. rated bunks

**CUSTOMER VALUE PACKAGE (MANDATORY)**

Dual 30-lb. propane bottles with easy access ABS cover
Outside shower
Water heater bypass
13,500-BTU A/C with directional/closeable vents
Microwave with built-in hood over range
Oven
ABS shower surround with bath skylight and fan

**ELITE PACKAGE**

Aluminum rims, power tongue jack, 8 cu. ft. Norcold refrigerator with hardwood insert and deluxe pillowtop mattress
---

**THERMAL PACKAGE**

Insulated, heated and enclosed underbelly and 2-sided reflective foil insulation in main roof and slideout roof
---

**OPTIONS**

Adjustable-pitch electric patio awning
Thermal-paned windows
Chil N' Stor outside baggage compartment with 1.7 cu. ft. exterior refrigerator (select models)
Electric stabilizer jacks
Electric tongue jack
Roof ladder
Spare tire with carrier
Outside kitchen (select models)
Outside bumper-mount grill
Bike rack/cargo tray system (select models)
Customer Value Package with 15,000-BTU A/C
Technology Package: 26" LCD HDTV and Premium
Multi-Media Sound System with CD/DVD player
(n/a on 33RLDS with Ledgestone fireplace option)
Free-standing table with 4 chairs (select models)
Bunks in lieu of dinette (26RKS)
Swivel rockers in lieu of dinette (2) (select models)
Swivel rockers in lieu of door-side sofa (2) (select models)
Door-side hide-a-bed sofa (33RLDS)
Hide-a-bed sofa (most models)
Ledgestone fireplace with 32" LED HDTV (select models)
Linoleum living area (select models)
50-amp service (select models)
2nd A/C in bedroom (select models)
Queen bed with bunk (19RD)
Trundle beds in lieu of J-Cube (select models)
J-Cube futon in lieu of folding bunk (33BHST)
Double bunk over double bed (select models)

**STANDARD EXTERIOR EQUIPMENT**

5/8" tongue-and-groove plywood floor decking
12" I-Class cambered structural-steel I-beam frame with fully integrated A-frame
Magnum truss roof system with one-piece seamless Alpha Ply
Two-sided reflective foil in flush-floor slideout floors
Electric powered slideouts with enclosed gear system
60" residential-style sliding patio door
Fold-away grab handles
Exterior marine-grade speakers (2)
G20 dark-tint windows
Vented front windows
Atrium-style front end laminated wall
Detachable hitch
Detachable power cord
Radial tires with galvanized-steel, impact-resistant wheel wells
E-Z Lube axles
Cable/satellite prep
Double-wide corner mold extrusions
Black tank flush sprayer
50-amp power service
Stabilizer jacks with sand pads (4)

**STANDARD INTERIOR EQUIPMENT**

90" interior height
Screwed-and-glued Glazed Concord Cherry cabinetry
Ball bearing drawer guides, 75-lb. capacity, full extension
18 cu. ft. residential-style 120V refrigerator with ice maker
3-burner range with 9,000-BTU SuperBurner and piezo igniter
Large 60/40 deep-bowl acrylic kitchen sink with high-rise faucet
10-gal. gas/electric DSI Atwood water heater
40,000-BTU Atwood auto ignition furnace with wall thermostat
Hidden switch command/charging center
Diamondflor vinyl flooring
Residential-grade carpet with padding
Vertical patio door blinds
120V ceiling fan in living room
Plated shades with box style valances and lambrequins
4" high-density foam, reversible dinette cushions
Plywood bed, dinette and bunk bases
J-Steel jack-knife sofa
Medicine cabinet with mirror
Porcelain stool with foot flush
300-lb. rated bunk beds
Sliding pocket-style bedroom/bunk room doors (select models)
Bedroom stereo speakers (2)

**CUSTOMER VALUE PACKAGE (MANDATORY OPTION)**

Dual 30-lb. propane tanks
Outside shower
13,500-BTU A/C with directional/closeable vents
Water heater bypass
Microwave with built-in hood over range
Oven
ABS shower surround with skylight and fan

**THERMAL PACKAGE**

Insulated, heated and enclosed underbelly and 2-sided reflective foil insulation in main roof and slideout roof
---

**OPTIONS**

Adjustable-pitch electric patio awning
RV door option in lieu of patio door (select models)
Slideout awnings
Thermal-paned, tinted, safety-glass windows
Spare tire with carrier
Outside bumper-mount grill
Roof ladder
Customer Value Package with 15,000-BTU A/C
32" LED HDTV
Ledgestone fireplace, facade and 32" LED TV (select models)
Fireplace
Hide-a-bed sofa with ottoman
Swivel rockers in lieu of door-side sofa (2) (select models)
Recliner in lieu of swivel chair (38FKDS and 38FLDS)
Recliners in lieu of door-side sofa (38RLTS)
Door-side hide-a-bed (38RLTS)
King bed
2nd A/C in bedroom

**STANDARD EXTERIOR EQUIPMENT**

Deluxe Graphics Package
102" wide-body construction
Magnum truss roof system with one-piece seamless Alpha Ply
5/8" tongue-and-groove plywood floor decking
12" I-Class cambered structural-steel I-beam frame with fully integrated A-frame
Two-sided reflective foil in flush-floor slideout floors
Electric-powered slideouts with enclosed gear system
60" residential-style sliding patio door
Fold-away grab handles
Exterior marine-grade speakers (2)
Patio awning
G20 dark-tint windows
Radial tires with galvanized-steel, impact-resistant wheel wells
E-Z Lube axles
Fiberglass atrium-style front cap
Detachable hitch
Outside shower
Black tank flush sprayer
50-amp power service

**STANDARD INTERIOR EQUIPMENT**

96" interior height
120V ceiling fan in living room and bedroom
Screwed-and-glued Glazed Concord Cherry cabinetry
Ball bearing drawer guides, 75-lb. capacity, full extension
18 cu. ft. residential-style 120V refrigerator with ice maker
20" free-standing 4-burner gas range with oven
Large 60/40 deep-bowl acrylic kitchen sink with high-rise faucet
10-gal. gas/electric DSI Atwood water heater
40,000-BTU Atwood auto ignition furnace with wall thermostat
Diamondflor vinyl flooring
Residential-grade carpet with padding
Vertical patio door blinds
Plywood bed and bunk bases
Air mattress hide-a-bed with pull-out storage drawer
Electric fireplace
Cable/satellite prep
Porcelain stool with foot flush
300-lb. rated bunk beds
Deluxe pillowtop mattress
Bedroom stereo speakers (2)

**CUSTOMER VALUE PACKAGE (MANDATORY OPTION)**

Dual 30-lb. propane bottles
Stabilizer jacks (4)
15,000-BTU A/C with directional/closeable vents
Water heater bypass
Microwave with built-in hood over range
Sink covers (2)
Multi-Media Premium Sound System CD/DVD with MP3 input jack
ABS tub surround with skylight and fan
Quilted bedspread

**THERMAL PACKAGE**

Insulated, heated and enclosed underbelly and 2-sided reflective foil insulation in main roof and slideout roofs
--

**OPTIONS**

Adjustable-pitch electric patio awning
Manual awning delete
Slideout awnings (2 or 3) (select models)
Thermal-paned, tinted, safety-glass windows
Spare tire
Outside bumper-mount grill
Roof ladder
20-gal. electric water heater
2nd glider/recliner (select models)
Ledgestone fireplace, facade and 40" LCD TV (select models)
Extendable dinette (40BHS)
Linoleum living area (select models)
Shower in lieu of garden tub
King bed
Rear queen bed (select models)
2nd A/C in bedroom (13,500-BTU)





# THE **Jayco**<sup>®</sup> family STORY

**THE JAYCO STORY BEGAN IN 1968 WITH OUR FAMILY—THE BONTRAGERS.** Lloyd Bontrager created an innovative, easy-to-use lifter system that led to a better fold-down camper. Loaded with more conveniences, he believed his camper would bring families closer together.

Since then, the Jayco family has grown. From our factory to our front office, from our salespeople to our suppliers, our family bond is four decades strong with the support of more than 300 Jayco dealers.

Together, we're helping make new family stories. **YOUR FAMILY STORY.**

## welcome to the Jayco family



Establishing a solid relationship with your local Jayco dealer is a key component in the enjoyment of your new Jayco. By purchasing from a local dealer, you will have a convenient location for sales, parts and service support. We hope you enjoy working with them as much as we do.



Jayco proudly sponsors Tread Lightly!, a nonprofit organization whose mission is to empower generations to enjoy the outdoors responsibly through education and restoration.

**Unloaded Vehicle Weight (UWV):** Sometimes referred to as "Dry Weight," UWV means the typical weight of this trailer as built at the factory. The UWV, as used in product literature and other promotional materials, does not include cargo, fresh water, propane, options or dealer-installed accessories.

**Gross Vehicle Weight Rating (GVWR):** GVWR means the maximum permissible weight of the trailer, including the UWV plus passengers, personal items, all cargo, fluids, options, and dealer-installed accessories. The GVWR is equal to or greater than the sum of the UWV and the CCC.



From RV insurance to extended warranties, JayPlus has it covered. Ask your Jayco dealer about our exclusive JayPlus program today.

**Cargo Carrying Capacity (CCC):** CCC means the maximum weight of all passengers, personal items, food, fresh water, propane, tools, other cargo and dealer-installed accessories that can be carried by the trailer. CCC is equal to or less than GVWR minus UWV. The addition of options will decrease the CCC.

**Hitch Weight (HW):** The hitch weight, as used in product literature and other promotional materials, does not include cargo, fresh water, propane gas, options or dealer-installed accessories. The addition of these types of items will either add to or subtract from the stated hitch weight.



Travel worry-free with Jayco's Customer First Roadside Assistance program, yours at no cost during your first year of ownership. This program is offered through Coach-Net, the largest RV emergency road service in the country, and gives you immediate access to dependable roadside assistance and support services with a simple phone call.



As a Jayco owner, you can be part of the Jayco Jafari International Travel Club. Ask your dealer about the Jafari "flight" in your area, write Jayco or visit our website.

It is important for your safety and enjoyment that your tow vehicle be adequately sized and equipped to tow and handle the GVWR of the RV you select. Review weights and rating of your tow vehicle and consult a competent advisor for questions or advice. Whether you are new to RVing or a veteran, get a feel for the performance of your tow vehicle before heading out on the roadways. When you tow an RV, you must drive differently than when you drive a single vehicle. Practice hooking up, driving, backing up and braking in a safe environment or seek out professional instruction. Jayco affixes a weight label to each RV which lists weight information for that vehicle. See specifications chart inside.

Jayco, Inc., P.O. Box 460, Middlebury, IN 46540, [www.jayco.com](http://www.jayco.com) 

See dealer for further information and prices. All information in this brochure is the latest available at the time of publication approval. Jayco reserves the right to make changes and to discontinue models without notice or obligation. Photos in this brochure may show optional equipment and props for photography purposes. RVs built for sale in Canada may differ to conform to Canadian codes. ©2012 Jayco, Inc. 13-JFLT-PL 0313-20K Printed in U.S.A.