

2004 Eagle™ Travel Trailers and Fifth Wheels by Jayco®

Find that special place where heaven and earth meet

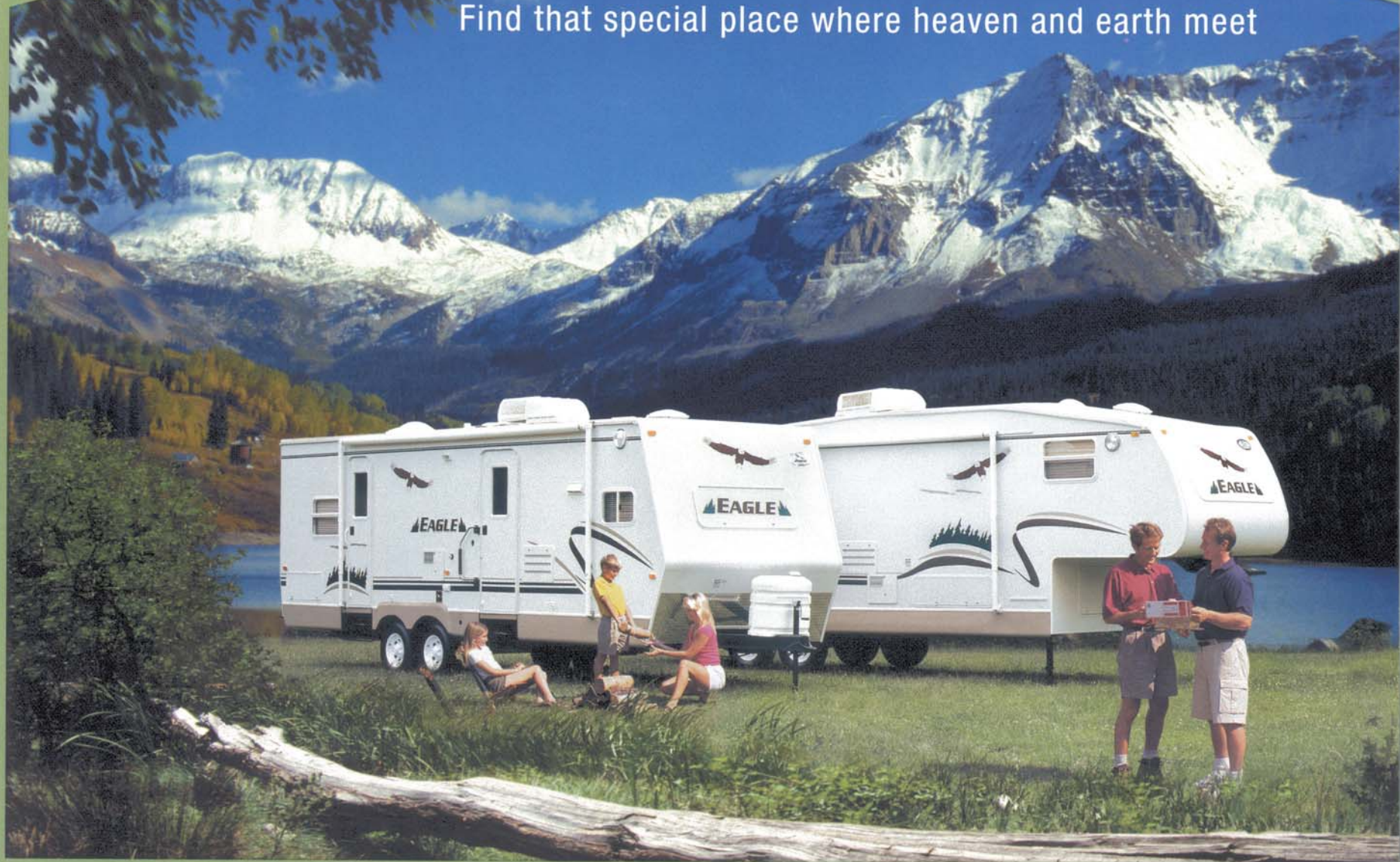



# Miles of open road... the perfect cure for stress.

You drive through breathtaking vistas with crisp mountain air and realize you can't remember the daily deadlines and hassles you left behind. Eagle™ travel trailers and fifth wheels take you on journeys to places where your only appointments are morning tee times or twilight sing-alongs.

Dine in spacious comfort at the slideout dinette, and in perfect view of your surroundings by the large dinette picture window. Freestanding table and chairs are optional.

The optional Samsung® microwave oven with carousel lets you cook your home meals quickly and easily.

Cooking is a breeze with the flush-mounted Norcold® double-door refrigerator, 3-burner range with 9,000-BTU SuperBurner™ and piezo igniter and deep residential-style sink with white arched-neck faucet.



Kick back after a day on your feet on the optional hide-a-bed sofa, which easily folds down into a flat, comfy bed. Sliders on the slideout end wall windows let in more air for better cross ventilation.



Find comfort in the well-equipped bathroom featuring ABS shower/tub surround and optional glass shower door.

Relax on the queen-size pillow-top innerspring mattress. Store all your clothes in the overhead cabinet, chest, wardrobes or under the bed that lifts easily on struts.

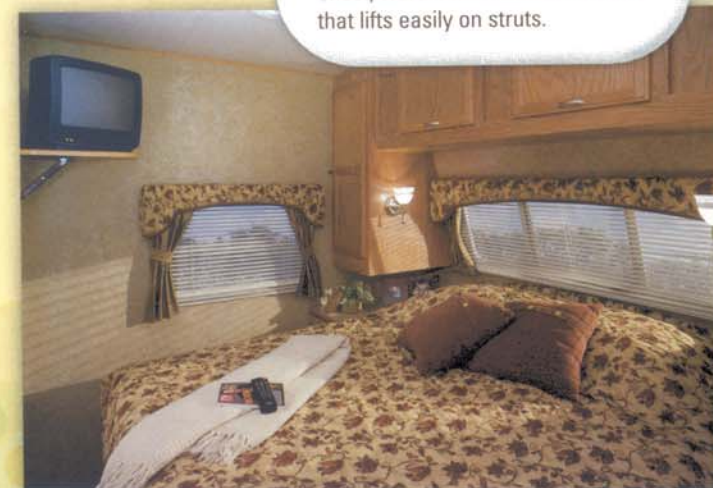
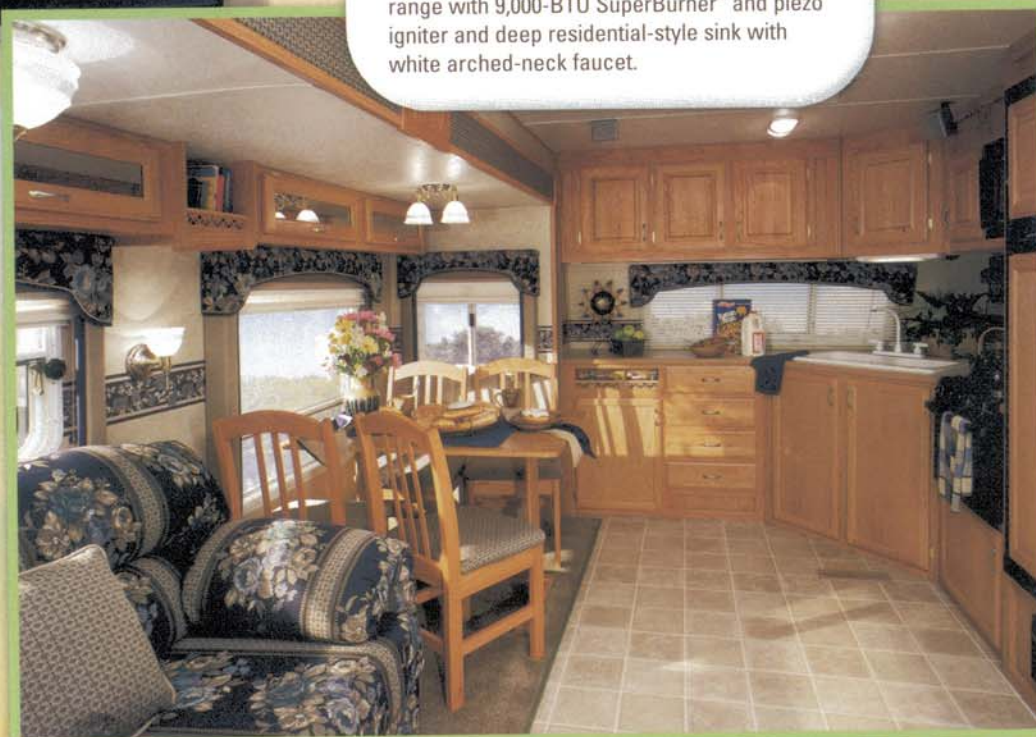
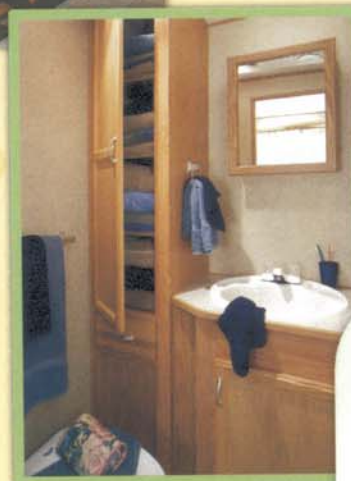





278 FBS interior

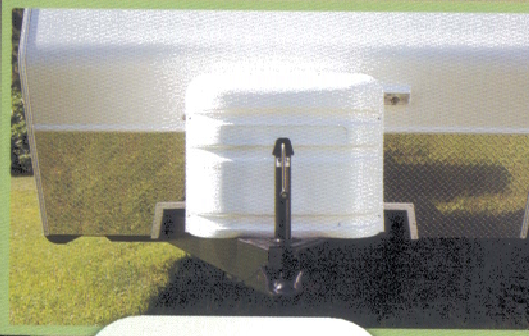

Diamond plate provides protection from rocks and road debris and adds sturdy good looks.



Get space for your fishing poles, oars and water skis in the convenient pass-through storage. (most models)



282 FKS



No expressways. No malls. No problems.



281 RLS

Get both electric front jacks and snap jacks as standard equipment.



The optional oversized folding entrance door exterior grab handle makes stepping in and out easier.

Store and protect loads of gear such as coolers and lawn chairs in the spacious front trunk – all fifth wheel models.





## 2004 Eagle™ Fifth Wheels



The optional hide-a-bed sofa with dual foot rests lets you stretch out after a long day hiking and converts to a comfortable bed for overnight guests.

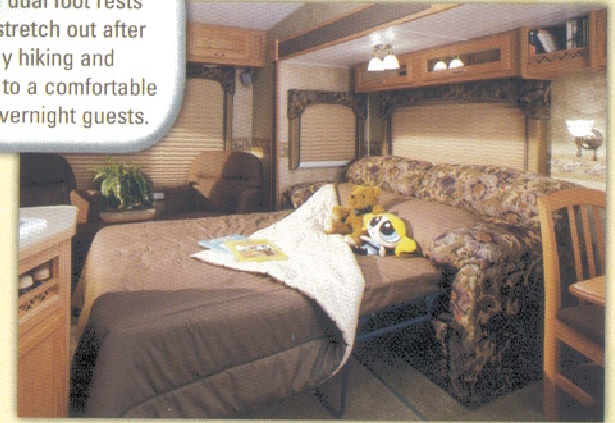

Beautiful oak cabinetry, coordinated quilted bedspread and padded carpet put you at ease.

The bathroom includes a handy laundry chute with basket (fifth wheels).









# 2004 Eagle™ Travel Trailer Floorplans – Continued

TABLE AND CHAIRS OPTION



TABLE AND CHAIRS OPTION

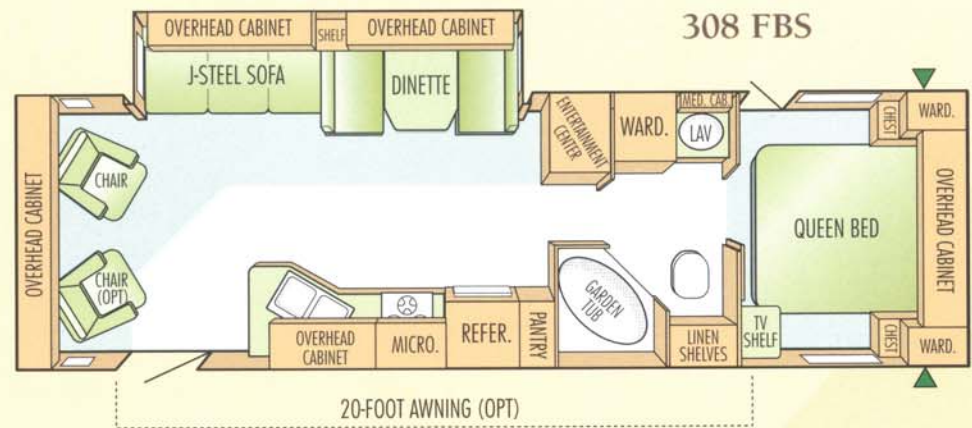
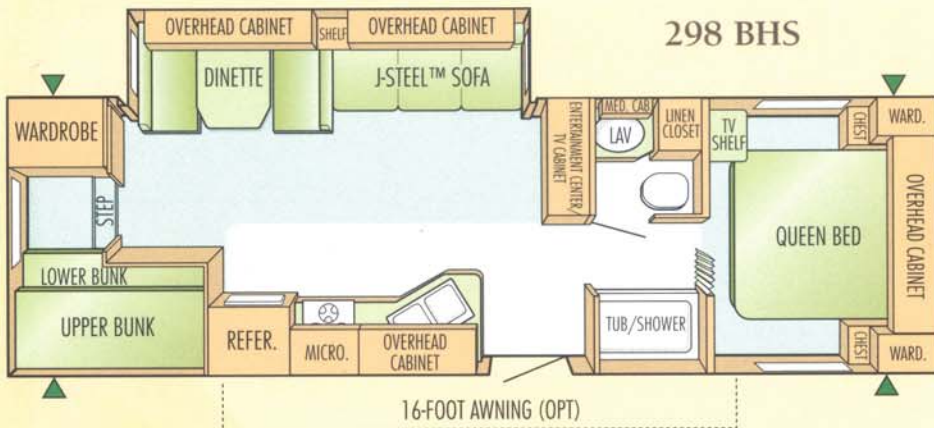

## Each Eagle Travel Trailer & Fifth Wheel is equipped with our CUSTOMER VALUE PACKAGE

- |  |   |
|--|---|
| 13,500 or 15,000 BTU central A/C             | Bath skylight   |
| Security lights (2)                          | 6-gal. gas/electric auto-ignition water heater                      |
| Folding exterior grab handle                 | Carefree® patio awning  |
| Power attic fan in bathroom w/wall switch    | Oak raised-panel doors in kitchen and living area overhead cabinets |
| Dolby® Digital 5.1 home theater system w/DVD | Oak raised-panel refrigerator doors                                 |
| Water purifier                               | Microwave oven w/carousel   |
| Deluxe pillow top mattress                   | Extra roof insulation   |
| Floor safe                                   |   |

TABLE AND CHAIRS OPTION





# 2004 Eagle™ Fifth Wheel Floorplans

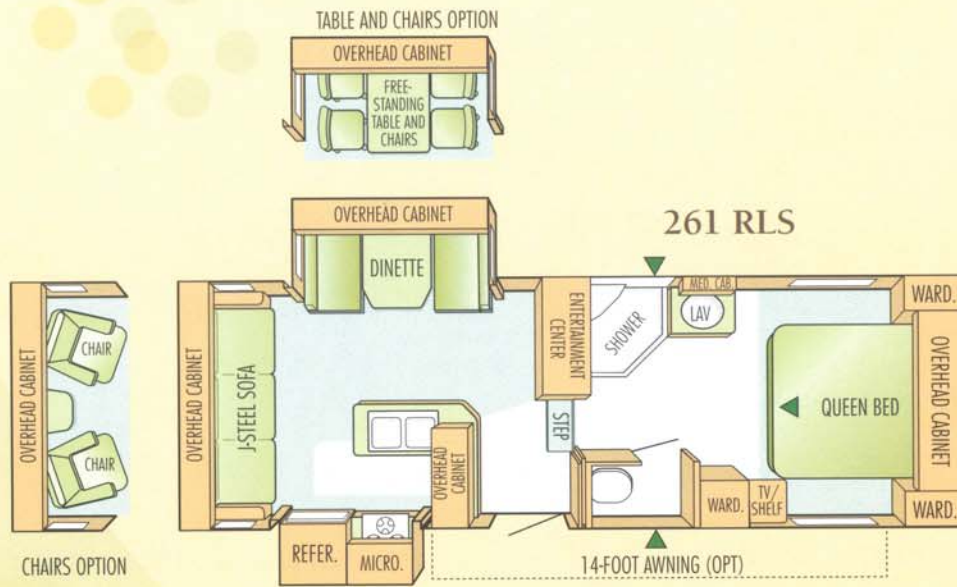

OUTSIDE STORAGE COMPARTMENT

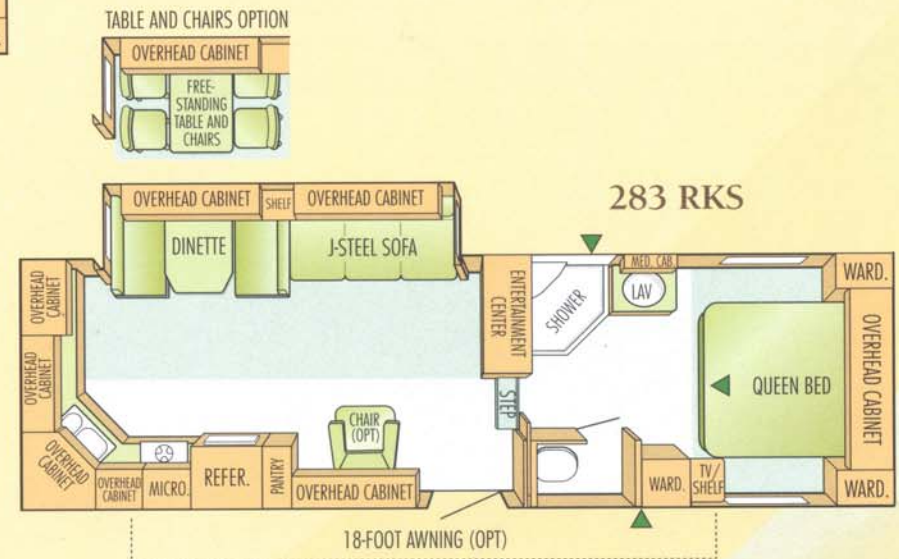

## 2004 Eagle™ Fifth Wheel Specifications

Models	Exterior Length	Exterior Height	Bedroom Interior Height	Unloaded Vehicle Weight (lbs.)	Dry Hitch Weight (lbs.)	Gross Vehicle Weight Rating (lbs.)	Cargo Carrying Capacity (lbs.)	Fresh Water Capacity <sup>^</sup> (gals.)	Gray Wastewater Capacity (gals.)	Toilet/Black Wastewater Capacity (gals.)
261 RLS	28'-5"	147"	77"	7715	1740	10,250	2535	46	74	37
281 RLS	30'-5"	147"	77"	7775	1795	9750	1975	46	74	37
283 RKS	31'-3"	147"	77"	7780	1475	9750	1970	46	74	37
293 RKS	30'-9"	147"	77"	8400	1610	10,500	2100	46	62	31
305 BHS	32'-5"	147"	77"	8080	1420	9750	1670	46	74	37

<sup>^</sup>Includes Water Heater



# 2004 Eagle™ Fifth Wheel Floorplans – Continued

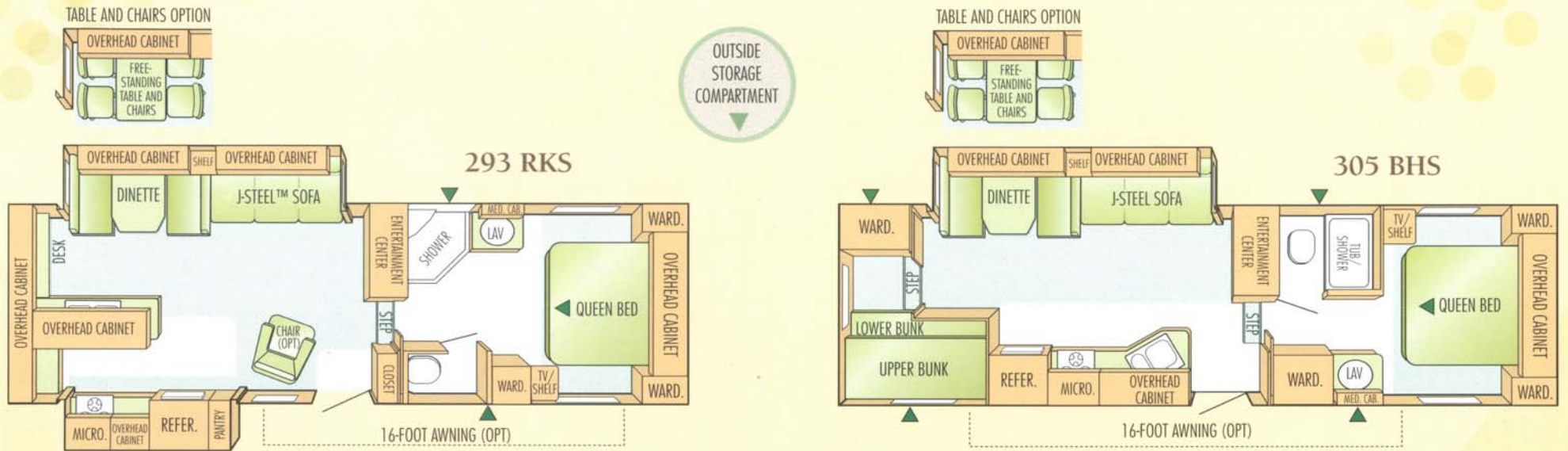

# 2004 Eagle™ Travel Trailer and Fifth Wheel Interior Color Selections



Basil



Paprika



Anise



# 2004 Eagle™ Travel Trailer and Fifth Wheel Standards and Options

## STANDARD EXTERIOR FEATURES

- Rear stabilizer jacks
- 15" radial tires
- E-Z Lube® axles
- Adjustable axle hangers (fifth wheels)
- PolyFlex™ underbelly covering
- Fiberglass stone guard on front window (travel trailers)
- Retractable triple entrance step
- 12V hitch light
- Patio light w/inside switch
- White-framed radius fiberglass main entry door
- White radius-cornered awning windows
- Hitch safety chains (travel trailers)
- Bumper w/drain hose carrier
- Screened egress bunk windows
- Champagne-colored radius skirting
- Electric powered front jacks (fifth wheels)
- Snap jacks (fifth wheels)
- \* Enclosed underbelly between main rails
- \* Heated and enclosed fresh water tank & holding tanks
- \* TuffShell™ aluminum framed vacuum bonded sidewalls
- \* Filon® Plus fiberglass exterior sidewalls
- \* Seamless rubber roof with 12-year warranty
- Radius-cornered, white-trimmed storage compartment doors w/grab handle

## STANDARD LIVING ROOM FEATURES

- Oak flat-panel doors and drawers
- \* Nickel/brass combination cabinet hardware
- J-Steel™ convertible sofa
- High-intensity lighting package
- Linoleum entryway
- Trackless carpeting w/pad
- 3 color-coordinated interior choices
- Fabric-covered box valances with lambrequin legs
- Mini blinds
- Crank-up TV antenna w/signal booster
- Cable TV hookup
- Decorative brass light at sofa and dinette
- TV overhead cabinet
- Overhead cabinets in slideout room
- Slider windows on slideout end walls
- \* Oak interior grab handle main entrance door
- \* Oak trim around main entrance door

\* New for 2004

## STANDARD BEDROOM FEATURES

- Bed lifts up easily on struts, storage below
- Coordinated, quilted bedspread
- TV cabinet or flip-up TV shelf (select models)
- Accordion door to bedroom (select models)
- Carpet and pad
- Large pass-through storage (select models)

## STANDARD BATHROOM FEATURES

- ABS tub/shower surround
- Medicine cabinet w/mirror
- Shower curtain (select models)
- Towel holder
- Switches for all lights
- Glass shower door (select models)
- Marine toilet
- \* Laundry chute with basket (fifth wheels)

## STANDARD KITCHEN FEATURES

- \* Residential-style white arched-neck faucet
- Deep residential-style sink
- Sink cover/cutting board (1)
- Color-coordinated countertops
- Flush-mounted double-door refrigerator
- Oversized oven
- Range hood w/light and fan
- 3-burner range w/9,000-BTU SuperBurner™ and piezo igniter
- Range cover
- Extra-long silverware drawer
- \* Large dinette picture window

## STANDARD HEAT, POWER AND WATER FEATURES

- Twin 30-lb. LP gas tanks w/regulator
- Water heater bypass system
- Winterization system
- City water hookup
- Systems monitor panel
- Demand water pump
- 12V electrical system w/deluxe 110V, 45-amp. converter
- 30-amp. power cord
- 110V exterior receptacle
- Auto-ignition furnace w/thermostat
- In-floor ducted heating

## CUSTOMER VALUE PACKAGE

- 13,500 or 15,000 BTU central A/C
- Security lights (2)
- Folding exterior grab handle
- Power attic fan in bathroom w/wall switch
- Dolby® Digital 5.1 home theater system w/DVD
- Water purifier
- Deluxe pillow top mattress
- Floor safe
- Bath skylight
- 6-gal. gas/electric auto-ignition water heater
- Carefree® patio awning
- Oak raised-panel doors in kitchen and living area overhead cabinets
- Oak raised-panel refrigerator doors
- Microwave oven w/carousel
- Extra roof insulation

## SAFETY

- LP gas detector
- Fire extinguisher
- Dead bolt lock on entrance doors
- Smoke detector
- Break away switch
- Multiple egress windows

## OPTIONAL FEATURES

- Customer value package with 13,500 or 15,000 BTU central A/C
- Free-standing table and 4 chairs
- Swivel rocker (select models)
- Hide-a-bed sofa w/footrest (select models)
- Glass shower door (select models)
- \* Linoleum in living area
- \* Diamond plate front panel (travel trailers) (mandatory)
- \* Day/night shades
- Tinted safety glass
- Roof ladder
- \* Stabilizer jacks (1-pr front) (travel trailers)
- \* ABS gas bottle cover (travel trailers)
- Large double-door 8-cu.-ft. refrigerator (select models)
- Outside portable gas barbecue grill with carrying case
- Center tension rafter
- Outside shower
- KidStuf™ bunk organizer(s) (select models)
- \* Bunk CD stereo (select models)
- 2-way radio system
- Spare tire and carrier
- Vinyl spare tire cover





# Strong Jayco® construction features give you peace of mind to relax.

4-1/2" bowed truss roof rafters

Insulated A/C ducting

R-11 insulation

3/8" roof decking

Seamless, one-piece rubber roof shrugs off the hardest rains, reflects heat and reduces noise.

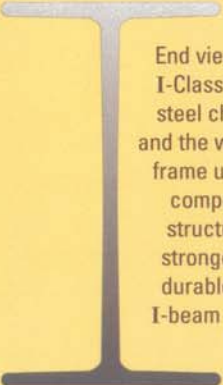
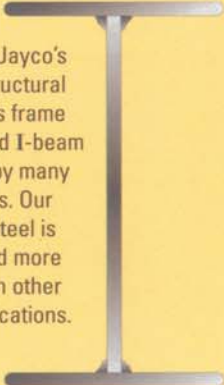
Jayco	Competition
	
End view of Jayco's I-Class™ structural steel chassis frame and the welded I-beam frame used by many competitors. Our structural steel is stronger and more durable than other I-beam applications.	



The height of your tow vehicle will never be a worry. Eagle™ fifth wheels feature standard Jake Plate™ adjustable axle hanger plates. Twice as strong as traditional single spring hangers, they allow you to adjust the axle height to accommodate tow vehicles of different heights.

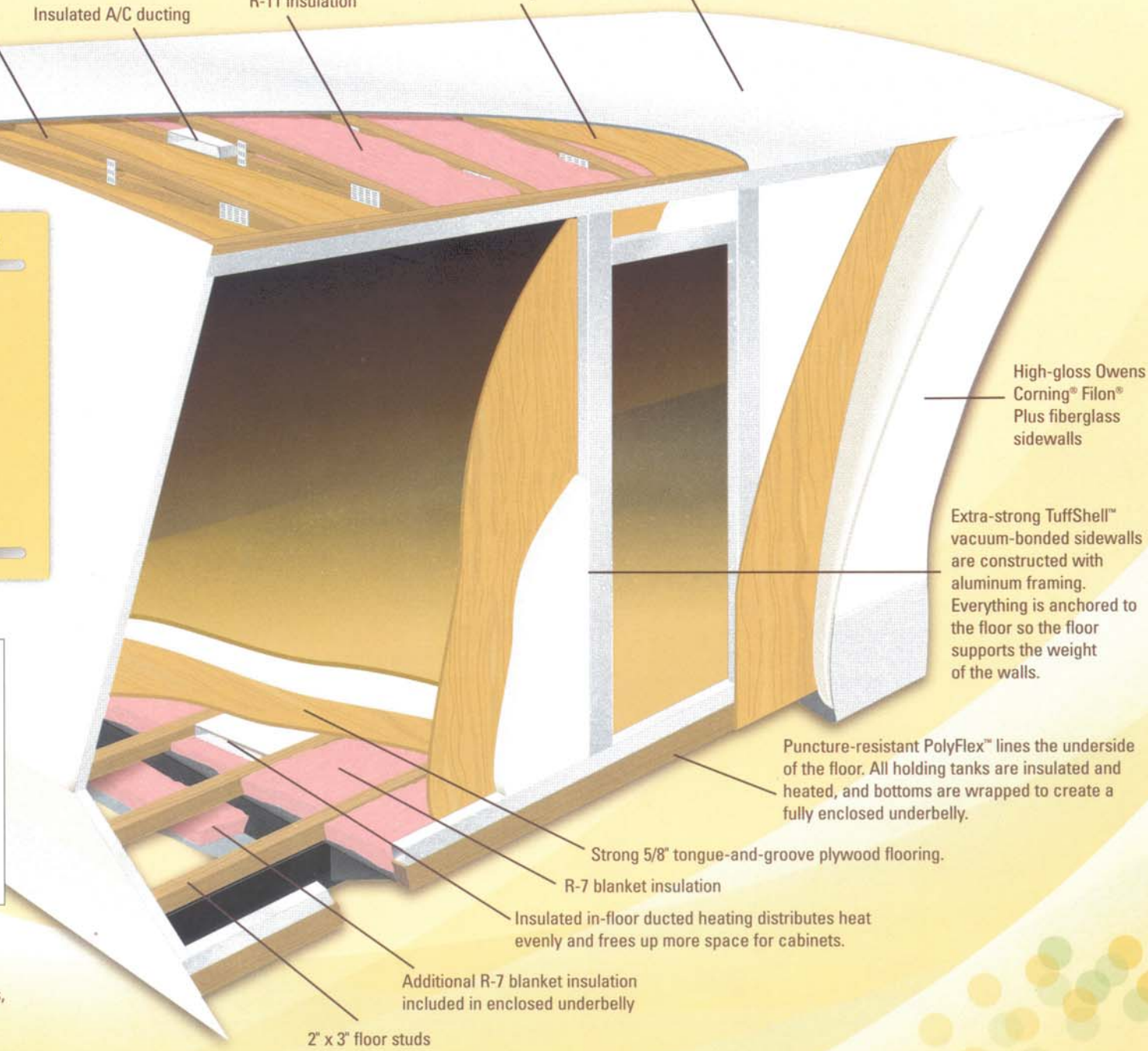

High-gloss Owens Corning® Filon® Plus fiberglass sidewalls

Extra-strong TuffShell™ vacuum-bonded sidewalls are constructed with aluminum framing. Everything is anchored to the floor so the floor supports the weight of the walls.

Puncture-resistant PolyFlex™ lines the underside of the floor. All holding tanks are insulated and heated, and bottoms are wrapped to create a fully enclosed underbelly.

Strong 5/8" tongue-and-groove plywood flooring.

R-7 blanket insulation

Insulated in-floor ducted heating distributes heat evenly and frees up more space for cabinets.

Additional R-7 blanket insulation included in enclosed underbelly

2" x 3" floor studs



# Enjoy Jayco's convenient Customer First Roadside Assistance



You can travel worry-free in your Eagle™ Recreational Vehicle and concentrate on having fun, thanks to Jayco's new Customer First Roadside Assistance program. This service, free during your first year of ownership, provides complete roadside assistance, emergency road service and special

support benefits that follow you wherever your travels take you. This program is offered through Coach Net, the largest RV emergency road service in the country. With a simple phone call, you get immediate access to dependable service when and where you need it, including:

- **Emergency Roadside Assistance.** Gain covered benefits with no out-of-pocket expense throughout the U.S. and Canada (includes one additional family car).
- **24-hour Toll-Free Emergency Message Service.** Stay in touch with family and friends anywhere in the country in case of an emergency.
- **\$500 Trip Interruption Reimbursement.** If you're in an accident, get reimbursement for your car rental, meals, lodging ... even a plane ticket home.

- **Toll-Free Nationwide Service Appointment Assistance.** Simply call us to set up an appointment where and when you want it and we'll take care of the rest.
- **Free Custom Trip Routing and Full Color Map Service.** Receive easy-to-follow maps, travel tips, places to see and much more.
- **Service Assistance.** Get simple directions to the closest of more than 6,800 qualified agencies throughout North America.
- **Free Dispatch of On-Site Mechanical Service in the Event of a Breakdown**
- **Free Jump Starts**
- **Free Tire Changes**
- **Free Fuel Delivery**
- **Free Lockout Service**
- **Free Travelers Checks**
- **\$1,000 Auto Theft or Hit-and-Run Reward**



In the heart of the Midwest, old-world craftsmen have handed down tried-and-true construction methods from generation to generation. At our headquarters in Middlebury, Indiana, Jayco® continues this tradition when building

all of our recreational vehicles. Our rugged designs, solid construction and commitment to quality add up to a well-built vehicle you can depend on for years.

See dealer for further information and prices.



FAMILY OWNED. FAMILY FOCUSED.

Jayco, Inc. P.O. Box 460 Middlebury, IN 46540  
[www.jayco.com](http://www.jayco.com)



As a Jayco owner, you can be part of the Jayco Jafari International Travel Club. Ask your dealer about the Jafari "flight" in your area, write Jayco direct or visit our Web site.

**Please Note:** All information in this brochure is the latest available at the time of publication approval. Jayco reserves the right to make changes and to discontinue models without notice or obligation.

Pictures in this brochure may show optional equipment. RVs built for sale in Canada may differ to conform to Canadian codes.

Printed on recycled paper.

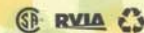

©2003 Jayco, Inc. 1003-120M Litho in U.S.A.



## WE BACK WHAT WE BUILD

The Jayco **2+3 Warranty** is a manufacturer's warranty. It doesn't come from your dealer, and it's not an extended warranty! It comes from the people who build Jayco recreational vehicles to the people who buy them. Each Jayco is warranteed to the original purchaser for twenty-four (24) months from the date of purchase against defects in materials and workmanship. This is

full hitch-to-bumper coverage on towables and bumper-to-bumper on motorized RVs. The Jayco warranty includes a three-year (3) structural guarantee. In addition, our warranty is transferable within the first two (2) years for a \$100 processing fee. Go ahead and compare the Jayco warranty with other manufacturers' warranties. You'll find it's the best in the business! For a copy of the warranty with full terms and conditions, ask your local Jayco dealer or visit our Web site.