

2019 JAY FLIGHT BUNGALOW



2019 JAY FLIGHT BUNGALOW



2
YEAR
WARRANTY



JAY FLIGHT BUNGALOW



40LOFT
WEIGHT: 11,725 lb.
DÉCOR: SADDLE
SLEEPS: 5-8



40LOFT LOFT



40LOFT BEDROOM



40LOFTS BATH



OPTIONAL FIBERGLASS EXTERIOR

JAY FLIGHT BUNGALOW FLOORPLANS

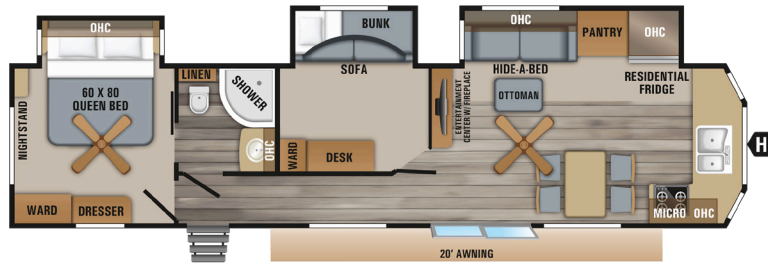

40BHTS OPTIONS: C, D, E

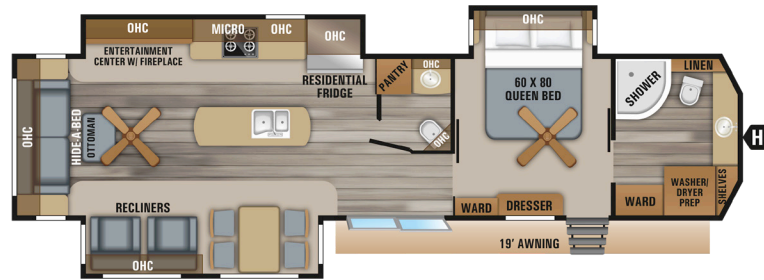

40FBTS OPTIONS: C, D

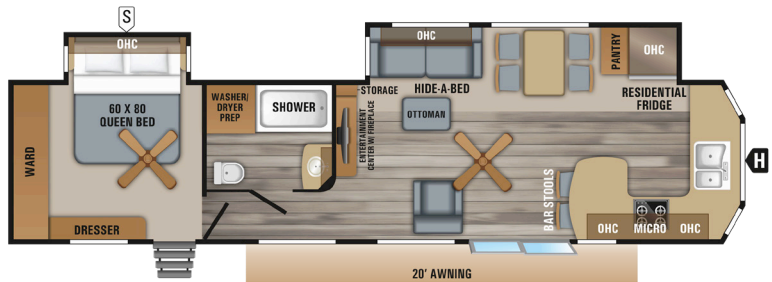

40FKDS OPTIONS: C, D, E

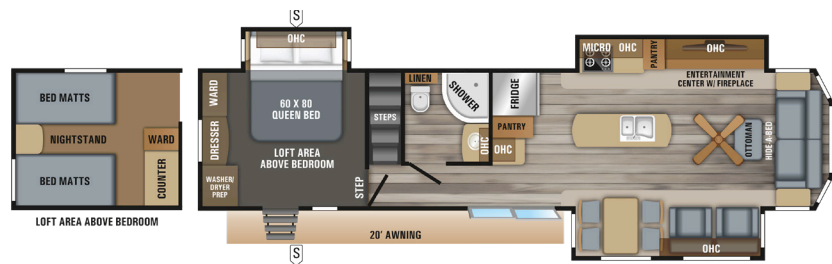

40LOFT OPTIONS: C, D

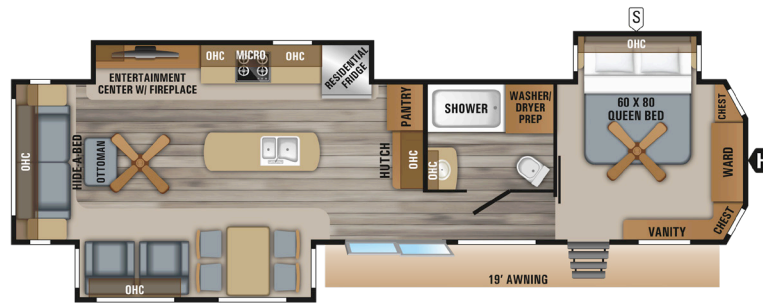

40RLTS OPTIONS: C, D

LEGEND

- STORAGE
- TRAILER HITCH
- BATHROOM SINK
- MEDICINE CABINET
- MICROWAVE
- OVERHEAD CABINETS
- REFRIGERATOR
- WARDROBE

OPTIONS

- OPTION A**
 HINGED BUNK
DINETTE
- OPTION B**
 HINGED BUNK
SOFA
- OPTION C**
 THEATER SEATING
- OPTION D**
 KING BED OPTION
KING BED
- OPTION E**
 HIDE-A-BED

Unloaded Vehicle Weight (UUV): Sometimes referred to as "Dry Weight," UUV means the typical weight of this trailer as built at the factory. The UUV, as used in product literature and other promotional materials, does not include cargo, fresh water, propane, options or dealer-installed accessories.

Gross Vehicle Weight Rating (GVWR): GVWR means the maximum permissible weight of the trailer, including the UUV plus personal items, all cargo, fluids, options and dealer-installed accessories. The GVWR is equal to or greater than the sum of the UUV and the CCC.

Cargo Carrying Capacity (CCC): CCC means the maximum weight of personal items, food, fresh water, propane, tools, other cargo and dealer-installed accessories that can be carried by the trailer. CCC is equal to or less than GVWR minus UUV. The addition of options will decrease the CCC.

Hitch Weight (HW): The hitch weight, as used in product literature and other promotional materials, does not include cargo, fresh water, propane gas, options or dealer-installed accessories. The addition of these types of items will either add to or subtract from the stated hitch weight. It is important for your safety and enjoyment that your tow vehicle be adequately sized and equipped to tow and handle the GVWR of the RV you select. Review weights and rating of your tow vehicle and consult a competent advisor for questions or advice. Whether you are new to RVing or a veteran, get a feel for the performance of your tow vehicle before heading out on the roadways. When you tow an RV, you must drive differently than when you drive a single vehicle. Practice hooking up, driving, backing up and braking in a safe environment or seek out professional instruction. Jayco affixes a weight label to each RV which lists weight information for that vehicle. See specifications chart.

SPECS

FLOORPLAN	EXTERIOR TRAVEL LENGTH	EXTERIOR WIDTH	EXTERIOR HEIGHT (WITH A/C)	INTERIOR HEIGHT	UNLOADED VEHICLE WEIGHT	DRY HITCH WEIGHT	GROSS VEHICLE WEIGHT RATING	CARGO CARRYING CAPACITY	FRESH WATER CAPACITY (INCLUDES WATER HEATER)	GREY WASTE WATER CAPACITY	BLACK WASTE WATER CAPACITY	SLEEP CAPACITY
40BHTS	40' 11"	8' 6"	12' 8"	8' 0"	10,850	1,660	13,000	2,150	48	78*	39	5 - 7
40FBTS	40' 2"	8' 6"	12' 7"	8' 0"	11,090	1,550	13,000	1,910	48	71.5*	78	3 - 4
40FKDS	40' 11"	8' 6"	12' 8"	8' 0"	10,690	1,620	13,000	2,310	48	39	39	3 - 4
40LOFT	40' 11"	8' 6"	13' 0"	8' 0"	11,725	1,585	13,000	1,525	48	71.5*	39	5 - 8
40RLTS	40' 2"	8' 6"	12' 7"	8' 0"	10,775	1,475	13,000	2,225	48	32.5	39	3 - 4

*Split tanks

STANDARDS AND OPTIONS

STANDARD EXTERIOR EQUIPMENT

102 inch wide body construction
 Magnum Truss™ Roof System with seamless DiFlex II material
 5/8 inch tongue and groove plywood floor decking
 12 inch, I-class™ cambered structural steel I-beams
 2 sided reflective foil in flush floor slideout room floors
 Electric powered slideout rooms with enclosed gear system
 Radial tires with galvanized steel, impact-resistant wheel wells
 60 inch, residential-style sliding patio door with Low-E™ thermal pane glass
 Exterior marine-grade speakers (2)
 G20 dark tint windows
 Atrium style front wall with integrated lights
 Utility lighting system
 Detachable hitch
 Outside shower
 Black tank flush sprayer
 Solar prep
 Power awning with LED light and speakers

STANDARD INTERIOR EQUIPMENT

96 inch interior height
 Seamless solid-surface look kitchen and bathroom countertops
 82 inch slideout room interior height
 84 inch tall interior doorways
 120V ceiling fan in living room and bedroom
 Raised panel cabinet doors with mortise and tenon corners
 Ball-bearing drawer guides, 75 lb. capacity, full extension
 18 cu. ft., residential-style, 120V refrigerator with ice maker
 20 inch freestanding 4 burner gas range with oven
 Large 60/40, deep bowl acrylic kitchen sink with residential pullout sprayer
 10 gallon gas/electric DSI water heater
 Auto ignition furnace
 Hardwood look vinyl flooring
 Residential Shaw® carpet with padding
 Roller shades in living room
 Pleated shades in bedroom
 Residential-style window treatments with wood trim

Hide-a-bed with tri-fold mattress and accent LED lighting
 Electric fireplace with thermostat controls
 Cable/satellite prep
 Hidden switch command/charging center
 Dual USB/12V charging port in bedroom
 Medicine cabinet with mirror (N/A 40FBTS)
 LED backlit bathroom mirror (40FBTS)
 Porcelain toilet with foot flush
 Simmons® pillow-top mattress
 Residential height master bed
 Bedroom stereo speakers (2) (N/A in 40LOFT)
 Plywood bed, dinette and bunk bases with 300 lb. rated bunks
 Central vacuum with push button retract for easy hose storage
 Electrical outlets in master bedroom on each side of the bed
 Vented end windows in living room and bedroom slideout rooms (select models)
 6 panel style bathroom and master bedroom doors
 Interior LED lighting
 Living room throw pillows
 Upgraded reading lights in master bedroom
 Decorative dinette ceiling light
 Smoked glass insert on select cabinets
 Crown molding on kitchen overhead cabinets
 Deluxe bar stools (40FKDS)
 Backup/security camera prep
 Living room crown molding
 Kitchen power vent with wall control
 Bathroom power vent with wall control

CUSTOMER VALUE PACKAGE (MANDATORY)

15,000 BTU central A/C
 30 lb. propane bottles with cover (2)
 Bath skylight
 Premium sound system with CD/DVD player, MP3 input and Bluetooth® and HDMI® connectivity
 Manual stabilizer jacks
 30 inch microwave
 Power vent in bathroom
 Quilted bedspread with pillows and shams

Sink covers (2)
 Tub surround
 Water heater bypass

OPTIONS

Customer Value Package (MANDATORY)
 Fiberglass sidewalls
 King bed
 Roof ladder
 Second A/C in bedroom (13,500 BTU) (N/A 40LOFT)
 Second A/C in loft (40LOFT)
 Second 20,000 BTU furnace (and a 35,000 BTU furnace)

replaces the 40,000 BTU furnace) (40LOFT)
 Slideout awnings
 Solid-surface kitchen countertops
 Stainless steel kitchen appliances
 Theater seats in main living area slideout room
 Enclosed underbelly with thermal package
 Thermal pane, tinted safety glass windows

INTERIOR DÉCOR

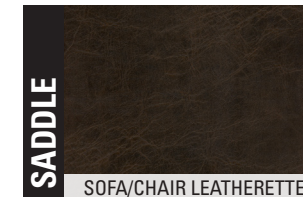

SADDLE

SOFA/CHAIR LEATHERETTE



MAIN ACCENT



BEDSPREAD



STERLING

SOFA/CHAIR MICROSUEDE



MAIN ACCENT



CARPET



TOFFEE

SOFA/CHAIR LEATHERETTE



MAIN ACCENT



ALL INTERIORS

LINOLEUM FLOORING



Meet your Jayco Dealer _____

Follow Jayco
 #Jayco50



Jayco, Inc. | P.O. Box 460 | Middlebury, IN 46540 See dealer for further information and prices. All information in this brochure and on www.jayco.com is the latest available at the time of publication approval. Jayco reserves the right to make changes and to discontinue models without notice or obligation. Photography may show optional equipment or props used for decoration purposes only. RVs built for sale in Canada may differ to conform to Canadian codes. JAYCO and the JAYCO BIRD IN FLIGHT are registered trademarks of Jayco, Inc. Printed in USA 15K 7/18 ©2018 Jayco, Inc. 274879-1

Travel with Confidence _____



At Jayco, we build our RVs to handle every adventure, then back them with our industry-leading 2-year limited warranty. We, with support from our select partners, have you covered for **2 camping seasons**. That's **730 days**. You won't find a better warranty in the business, because the only strings we attach are those that deliver the ultimate in reliability. That's the Jayco difference. So go explore. For a copy of our 2-year limited warranty with complete terms and conditions, please contact your local Jayco dealer.