

# CAMPING TRAILERS

SIMPLE SETUP. BUILT TO LAST.

# easy camping



# five **LIFETIME WARRANTIES**

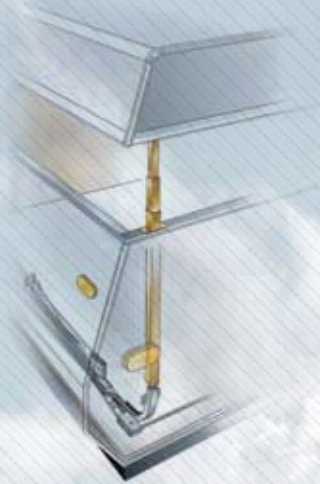

## 1 LIFTER SYSTEM

Fully enclosed (n/a Sport) to protect against road debris and rust, our one-of-a-kind, patented lifter system uses strong, flexible push-rods to guide the roof, while our three-stage tubular lift posts include nylon bushings to reduce friction, shed water and protect the tent fabric.

## 2 BED PLATFORM

A two-piece extruded aluminum bed frame, 1/2" decking and heavy-duty bed supports hold up to 1,050 pounds.



## 5-YEAR TENT WARRANTY

Our DuraTek water-repellent tent material, double-stitched in our own factory, is built to resist mildew, mold, scratches and cracks.



1,050-LB. RATED BUNK ENDS



## YOU WANT PEACE OF MIND

That's why we offer our exclusive 2-year Co-Pilot Warranty, the industry's best and most comprehensive warranty program.



Committed to quality, we back our camping trailers with five lifetime component warranties, a 5-year tent warranty and an industry-leading 2-year warranty. Simply put, you can camp easy knowing we stand behind our product.

### 3 ROOF

Jayco's fiberglass roof features a unique dome design for better water runoff and one-piece construction for superior leak prevention, ensuring your RV will weather the elements.

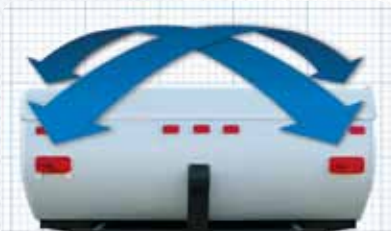

SEAMLESS DOME ROOF

### 4 FRAME

Powder coated to prevent corrosion, Jayco's custom-built frame features an integrated, unwelded A-frame design that prevents buckling for the ultimate in longevity.



INTEGRATED A-FRAME

### 5 FLOOR

Jayco wraps its one-piece Structurwood with water-resistant Poly Flex material. Using glue and screws to double bond the floor to the frame, Jayco's camping trailers boast one of the industry's strongest foundations.



POLY FLEX-WRAPPED FLOOR

## WITH YOUR PURCHASE

Every Jayco RV undergoes rigorous quality control testing before it leaves the factory, so you can be confident your new Jayco will continue to provide the ultimate in reliability for years to come.

For a copy of our 2-year Co-Pilot limited warranty with full terms and conditions, ask your local Jayco dealer.



TO LEARN MORE ABOUT OUR QUALITY CONTROL TESTING, SCAN HERE WITH YOUR SMARTPHONE.



JAY SERIES SPORT CAMPING TRAILERS BY JAYCO



the *perfectly-priced* pop-up

Camp in comfort—without breaking the bank. More affordable than ever, Jay Series Sport combines amenities you need at a price you can afford in six low-maintenance floorplans.



REVERSIBLE CUSHIONS

## FAMILY-FRIENDLY FEATURES

Reversible dinette cushions with EZ-clean vinyl backs (Customer Value Package), seamless Diamondfloor vinyl flooring and an optional outside shower make cleanup effortless in a Jay Series Sport.



JAY SERIES SPORT 10FD



JAY SERIES SPORT 10FD

## SLEEPS UP TO 8

Thanks to 1,050-lb. rated bunk ends, convertible dinettes and gauchó sofa sleepers, there's a sleeping arrangement for your family.



JAY SERIES SPORT 10FD

## FLOORPLANS

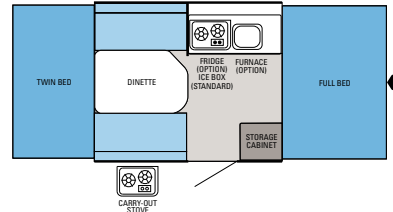

### JAY SERIES SPORT | 8

Ext. Length: 11' 7" Travel Ht.: 57" Unloaded Wt. (lbs.): 1,190 Sleeps: 5-6

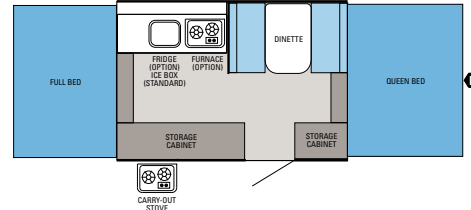

### JAY SERIES SPORT | 10

Ext. Length: 13' 6" Travel Ht.: 57" Unloaded Wt. (lbs.): 1,370 Sleeps: 5-6

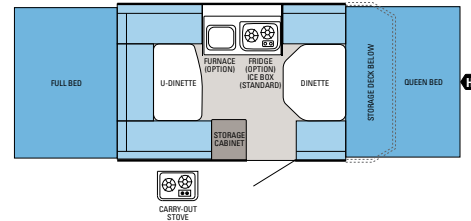

### JAY SERIES SPORT | 10FD

Ext. Length: 16' 6" Travel Ht.: 58" Unloaded Wt. (lbs.): 1,500 Sleeps: 6-7

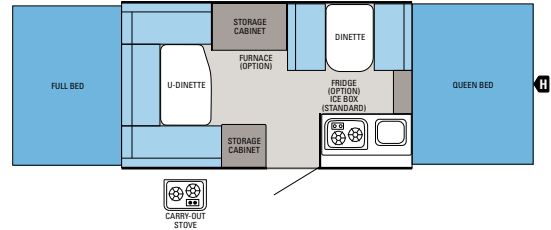

### JAY SERIES SPORT | 12

Ext. Length: 15' 6" Travel Ht.: 56" Unloaded Wt. (lbs.): 1,465 Sleeps: 6-8

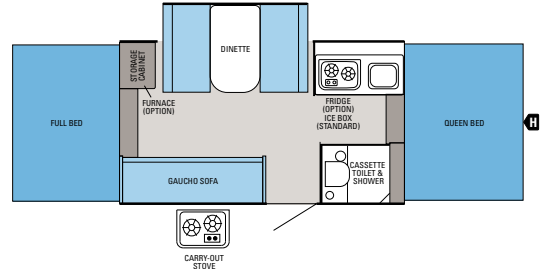

### JAY SERIES SPORT | 12BS

Ext. Length: 15' 6" Travel Ht.: 59" Unloaded Wt. (lbs.): 1,915 Sleeps: 6-7

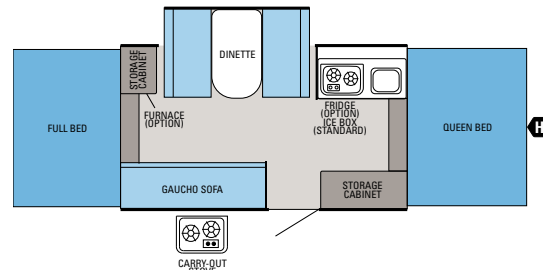

### JAY SERIES SPORT | 12SC

Ext. Length: 15' 6" Travel Ht.: 59" Unloaded Wt. (lbs.): 1,805 Sleeps: 6-7



JAY SERIES CAMPING TRAILERS BY JAYCO



the fold-down *favorite*

Popular by demand, Jay Series combines a full-featured kitchen, sleeping for up to eight and a host of high-end amenities in five family-friendly floorplans.



STANDARD ELECTRIC LIFTER SYSTEM

**ELECTRIC LIFTER SYSTEM**

A standard electric lifter system, complete with hand-held remote, makes setting up camp easier, while load-sensing electronics prevent the roof from being damaged.



JAY SERIES 1207

JAY SERIES 1207

## GRAB HANDLE

A new foldable grab handle makes getting in and out easier, while the door's removable hinge allows access when the roof is lowered.

## FLOORPLANS

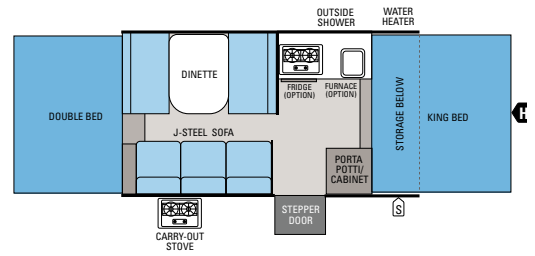

### JAY SERIES | 1006

Ext. Length: 16' 2" Travel Ht.: 61" Unloaded Wt. (lbs.): 2,015 Sleeps: 6-7

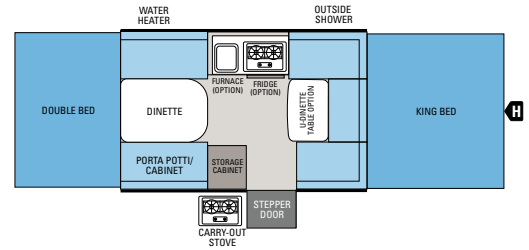

### JAY SERIES | 1007

Ext. Length: 14' 2" Travel Ht.: 59" Unloaded Wt. (lbs.): 1,725 Sleeps: 6-8

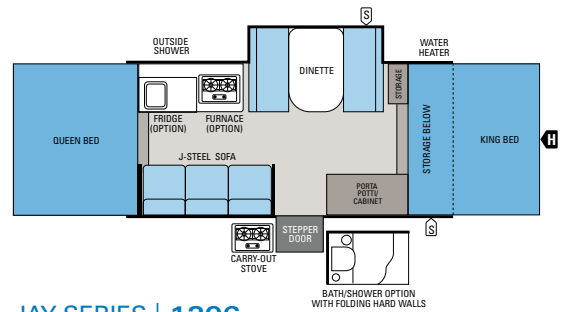

### JAY SERIES | 1206

Ext. Length: 18' 2" Travel Ht.: 61" Unloaded Wt. (lbs.): 2,475 Sleeps: 6-7

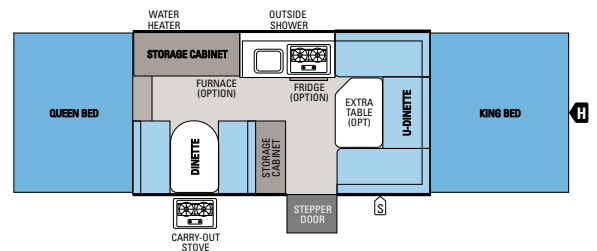

### JAY SERIES | 1207

Ext. Length: 16' 2" Travel Ht.: 61" Unloaded Wt. (lbs.): 1,965 Sleeps: 6-7

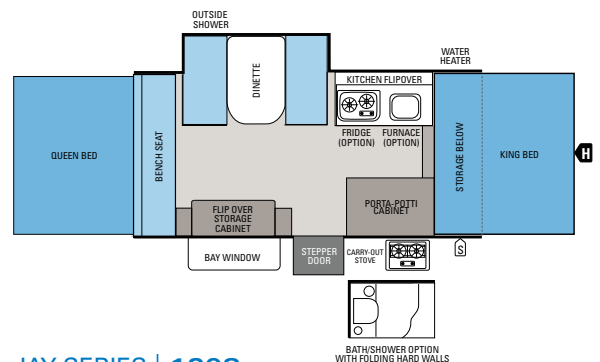

### JAY SERIES | 1208

Ext. Length: 18' 2" Travel Ht.: 61" Unloaded Wt. (lbs.): 2,485 Sleeps: 5-6



BAJA CAMPING TRAILERS BY JAYCO



## the *toy-toting* camper

Built for adventure and comfort, Baja packs a hard-core utility deck and 15" off-road Dunlop Mud Rover tires into two feature-filled floorplans. Sporting king-sized sleeping, this toy-toting camping trailer can accommodate up to eight overnight guests, while a three-burner stove, microwave oven, refrigerator and Concord Cherry cabinetry complete the interior package.





BAJA 10G



BAJA 10G



BAJA UTILITY DECK

BAJA 10G

## FLOORPLANS

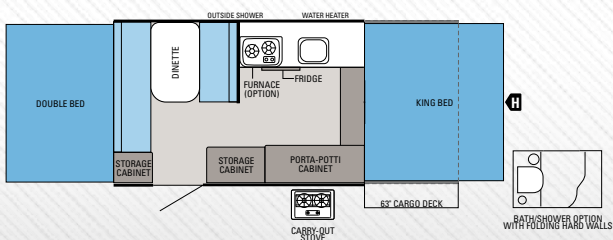

### BAJA | 10G

Ext. Length: 20' 6" Travel Ht.: 69" Unloaded Wt. (lbs.): 2,470 Sleeps: 5-6

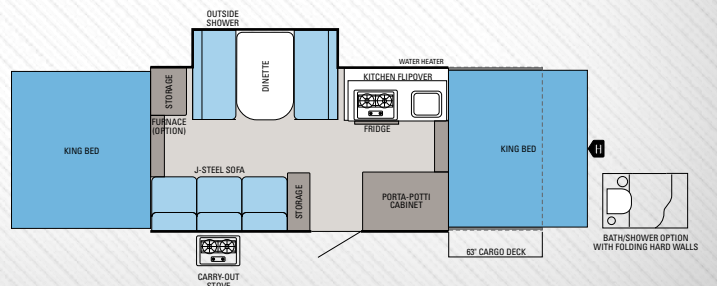

### BAJA | 12E

Ext. Length: 22' 6" Travel Ht.: 69" Unloaded Wt. (lbs.): 2,910 Sleeps: 6-8

## JAYCO'S FEATURE-PACKED CAMPING TRAILERS...



### *designed with comfort in mind*

Jayco camping trailers feature Amish-crafted cabinetry with ball bearing drawer guides, just one of many durable details that will outlast everything but your memories.

### BUNK-END LIGHTS

Standard bunk-end lights provide evening reading light while doubling as a fan (n/a Sport).

### WATER FILTRATION

A water filtration system makes for tastier water in Jay Series and Baja.

### BATTERY GAUGE

Take the guess work out of keeping your RV powered up thanks to the Baja's battery voltage gauge (Customer Value Package).

### SPECIFICATIONS

	FLOORPLAN	EXT. LENGTH	CAMPSITE LENGTH	EXT. WIDTH	TRAVEL HEIGHT	UNLOADED VEHICLE WEIGHT (LBS.)	DRY HITCH WEIGHT (LBS.)	GROSS VEHICLE WEIGHT RATING (LBS.)	CARGO CARRYING CAPACITY (LBS.)	FRESH WATER CAPACITY (GAL.)	GRAY WASTEWATER CAPACITY (GAL.)	TOILET/BLACK WASTEWATER CAPACITY (GAL.)
JAY SERIES SPORT	8	11' 7"	16' 2"	85"	57"	1,190	185	1,995	805	10	n/a	n/a
	10	13' 6"	19' 6"	85"	57"	1,370	160	2,250	880	10	n/a	n/a
	10FD	16' 6"	20' 11"	85"	58"	1,500	190	2,350	850	10	n/a	n/a
	12	15' 6"	21' 6"	85"	56"	1,465	210	2,350	885	10	n/a	n/a
	12BS	15' 6"	21' 6"	85"	59"	1,915	225	2,700	785	10	n/a	5
	12SC	15' 6"	21' 6"	85"	59"	1,805	210	2,550	745	10	n/a	n/a
JAY SERIES	1006	16' 2"	20' 10"	85"	61"	2,015	215	2,950	935	17	0	0
	1007	14' 2"	20' 10"	85"	59"	1,725	150	2,550	825	17	0	0
	1206	18' 2"	23' 4"	85"	61"	2,475	320	3,450	975	17	11*	5*
	1207	16' 2"	23' 4"	85"	61"	1,965	170	2,950	985	17	0	0
	1208	18' 2"	23' 4"	85"	61"	2,485	270	3,490	1,005	17	11*	5*
	BAJA	10G	20' 6"	24' 2"	85"	69"	2,470	300	4,550	2,080	30.5	11*
12E		22' 6"	27' 6"	85"	69"	2,910	370	4,850	1,940	30.5	11*	5*

\*With optional bath/shower. Note: The weights of certain options and/or option packages are not included in the UWW listed in the specification charts.

### INTERIOR DÉCOR

#### JAY SERIES SPORT

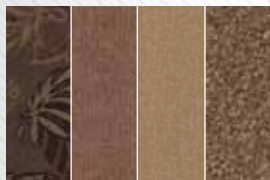

#### JAY SERIES

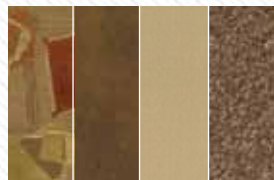

#### BAJA

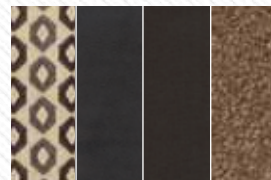

#### WOOD



**eCO advantage™** [www.jayco.com/ecoadvantage](http://www.jayco.com/ecoadvantage)

THE JAYCO ECOADVANTAGE IS OUR COMPANY'S COMMITMENT TO PROTECTING THE ENVIRONMENT. Scan this QR code with your smartphone to watch a video about our efforts and the impact we're making on our planet.

## STANDARDS AND OPTIONS

### JAY SERIES SPORT

#### STANDARD EXTERIOR EQUIPMENT

Heavy-duty, corrosion-resistant A-frame construction  
 Floor constructed of one-piece Structurwood and wrapped with Poly Flex underbelly material  
 Scratch-resistant, embossed aluminum exterior finish  
 Mildew-resistant aluminum ceiling  
 Domed, seamless fiberglass roof  
 Lifter post covers integrated into tent  
 DuraTek water-repellent sectionalized tent with 1,050-lb. rated beds  
 One-piece construction entrance door with self-storing screen door and access when roof is lowered  
 Heavy-duty entrance door securement latches  
 12" C-range tires  
 Leaf spring suspension system  
 12V electrical system with 110V converter  
 20-lb. propane gas bottle  
 30-amp power cord  
 120V G.F.C.I. protected exterior receptacle  
 Prep wiring for battery  
 Bumper-welded steel construction  
 Leveling tongue jack

#### STANDARD INTERIOR EQUIPMENT

Concord Cherry cabinetry  
 Ball bearing drawer guides, 75-lb. capacity with full-drawer extension  
 Door pulls with roller catch  
 Acrylic sink and faucet  
 Appliances, pre-plumbed for propane  
 35-lb. ice box  
 Booth dinette with carry-out table  
 Coordinated furniture, designed and made by Jayco  
 Tinted vinyl windows with fine-mesh screening  
 Window drapes and 4" ceiling valances  
 Wall-to-wall Diamondflor vinyl flooring  
 Auxiliary 12V jack and privacy curtains for bunk ends  
 Cassette toilet and shower (12BS)

#### CUSTOMER VALUE PACKAGE

14" x 14" roof vent  
 E-Z Lube axles  
 Crank-down rear stabilizer jacks with sand pads (2)  
 Stainless-steel, carry-out stove with wind deflectors  
 10-gal. fresh water system with 12V demand pump  
 Non-sliding, 4" deep cushions for dinette with reversible EZ-Clean vinyl backs

#### OPTIONS

Self-storing awning made by Jayco  
 Electric brakes  
 Spare tire with carrier and cover  
 Prep for A/C, includes wiring, roof supports, 120V outlet and wire sleeve cover  
 16,000-BTU furnace with auto ignition  
 2-cu. ft. 3-way gas/electric refrigerator (110V/12V/propane)  
 Deluxe Plumbing Package: Outside shower and 6-gal. water heater (select models)  
 Heated bed mats (2)

### JAY SERIES

#### STANDARD EXTERIOR EQUIPMENT

Heavy-duty, corrosion-resistant A-frame construction  
 Floor constructed of one-piece Structurwood and wrapped with Poly Flex underbelly material  
 Scratch-resistant, embossed aluminum exterior finish  
 Mildew-resistant aluminum ceiling  
 Domed, seamless fiberglass roof  
 14" x 14" roof vent  
 Prep for A/C accommodating all roof-mounted A/Cs  
 Roof prepped for bike carrier  
 Jayco's original, fully enclosed lifter system with lifter post covers integrated into tent (same design used since 1968)  
 Power roof lift with hand-held remote key fob  
 DuraTek water-repellent sectionalized tent with 1,050-lb. rated beds  
 Permanently attached bed support poles  
 Diamond plate on front and rear walls  
 One-piece construction entrance door with self-storing screen door and access when roof is lowered  
 Stepper door  
 12" D-range tires (1007)  
 13" C-range tires (1006 and 1207)  
 13" D-range tires (1206 and 1208)  
 TorFlex independent torsion axle suspension  
 Spare tire and tire carrier with vinyl tire cover  
 Stainless-steel, carry-out stove with wind deflectors  
 Outside shower  
 12V electrical system with 110V converter  
 30-amp power cord  
 Prep wiring for battery  
 Bumper-welded steel construction  
 Crank-down stabilizer jacks with sand pads  
 Leveling tongue jack

#### STANDARD INTERIOR EQUIPMENT

Concord Cherry cabinetry with raised-panel doors  
 Real-wood drawers with ball bearing drawer guides, 75-lb. capacity and full-drawer extension  
 Acrylic sink and faucet  
 6-gal. water heater  
 17-gal. fresh water system with 12V demand pump  
 Water heater bypass system  
 Appliances, pre-plumbed for propane  
 Booth dinette with carry-out table  
 Non-sliding, 4" deep cushions for dinette with reversible EZ-clean vinyl backs  
 Coordinated furniture, designed and made by Jayco  
 J-Steel sofa (select models)  
 SoftShade window shades and valances  
 Tinted vinyl windows with fine-mesh screening  
 Porta-potti storage cabinet (select models)  
 Wall-to-wall Diamondflor vinyl flooring  
 Auxiliary 12V jack and privacy curtains for bunk ends

#### CUSTOMER VALUE PACKAGE

Self-storing awning made by Jayco  
 2-cu. ft. 3-way gas/electric refrigerator (110V/12V/propane)  
 Water purification system  
 Bunk-end fan lights (2)

#### OPTIONS

Deluxe screen room  
 Electric brakes (standard on select models)  
 Hydraulic surge brakes  
 Outside grill  
 Multi-Media stereo with outside speakers  
 16,000-BTU furnace with auto ignition  
 2nd table with pedestal leg (select models)  
 Bath/shower with hard walls and shower curtain (select models)  
 Heated bed mats (2)  
 Powered roof vent

### BAJA

#### STANDARD EXTERIOR EQUIPMENT

Heavy-duty, corrosion-resistant A-frame construction  
 Floor constructed of one-piece Structurwood and wrapped with Poly Flex underbelly material  
 Scratch-resistant, embossed aluminum exterior finish  
 Mildew-resistant aluminum ceiling  
 Domed, seamless fiberglass roof  
 14" x 14" roof vent  
 Prep for A/C accommodating all roof-mounted A/Cs  
 Prepped for bike carrier  
 Jayco's original, fully enclosed lifter system with lifter post covers integrated into tent (same design used since 1968)  
 Power roof lift with hand-held remote key fob  
 DuraTek water-repellent sectionalized tent with 1,050-lb. rated beds  
 Permanently attached bed support poles  
 Diamond plate on front and rear walls  
 One-piece construction entrance door with self-storing screen door and access when roof is lowered  
 15" off-road Dunlop Mud Rover radial tires  
 Electric brakes  
 E-Z Lube axles with leaf spring suspension system  
 Spare tire and tire carrier with vinyl tire cover  
 Utility deck, rated for 1,500 pounds, with ramps/deck railing (dual use) with quick-connect deck attachment system  
 Stainless-steel, carry-out stove with wind deflectors  
 Outside shower  
 Double 20-lb. propane gas bottles with vinyl cover  
 12V electrical system with 110V converter  
 30-amp power cord  
 Prep wiring for battery  
 Bumper-welded steel construction with 4" tubular steel rear bumper  
 Crank-down stabilizer jacks with sand pads  
 Leveling tongue jack

#### STANDARD INTERIOR EQUIPMENT

Concord Cherry cabinetry with raised-panel doors  
 Real-wood drawers with ball bearing drawer guides, 75-lb. capacity and full-drawer extension  
 Acrylic sink and faucet  
 6-gal. water heater  
 30-gal. fresh water system with 12V demand pump  
 Water heater bypass system  
 Appliances, pre-plumbed for propane  
 2 cu. ft. 3-way gas/electric refrigerator (110V/12V/propane)  
 Booth dinette with carry-out table  
 Non-sliding, 4" deep cushions for dinette with reversible EZ-clean vinyl backs  
 Coordinated furniture, designed and made by Jayco  
 J-Steel sofa (select models)  
 SoftShade window shades and valances  
 Tinted vinyl windows with fine-mesh screening  
 Porta-potti storage cabinet (select models)  
 Wall-to-wall Diamondflor vinyl flooring  
 Bunk-end fan lights (2)  
 Auxiliary 12V jack and privacy curtains for bunk ends

#### CUSTOMER VALUE PACKAGE

Self-storing awning made by Jayco  
 Solar prep  
 Polished aluminum rims  
 Multi-Media stereo with outside speakers  
 Battery gauge  
 Water purification system

#### OPTIONS

Deluxe screen room  
 Front storage box  
 Outside grill  
 16,000-BTU furnace with auto ignition  
 Bath/shower with hard walls and shower curtain (select models)  
 Heated bed mats (2)  
 Powered roof vent



FOR A COMPLETE LIST OF STANDARDS AND OPTIONS, SCAN HERE WITH YOUR SMARTPHONE OR VISIT JAYCO.COM.



# THE **Jayco**<sup>®</sup> family STORY

**THE JAYCO STORY BEGAN IN 1968 WITH OUR FAMILY—THE BONTRAGERS.** Lloyd Bontrager created an innovative, easy-to-use lifter system that led to a better fold-down camper. Loaded with more conveniences, he believed his camper would bring families closer together.

Since then, the Jayco family has grown. From our factory to our front office, from our salespeople to our suppliers, our family bond is four decades strong with the support of more than 300 Jayco dealers.

Together, we're helping make new family stories. **YOUR FAMILY STORY.**

welcome to the **Jayco family**



Establishing a solid relationship with your local Jayco dealer is a key component in the enjoyment of your new Jayco. By purchasing from a local dealer, you will have a convenient location for sales, parts and service support. We hope you enjoy working with them as much as we do.



Jayco proudly sponsors Tread Lightly!, a nonprofit organization whose mission is to empower generations to enjoy the outdoors responsibly through education and restoration.

**Unloaded Vehicle Weight (UWV):** Sometimes referred to as "Dry Weight," UWV means the typical weight of this trailer as built at the factory. The UWV, as used in product literature and other promotional materials, does not include cargo, fresh water, propane, options or dealer-installed accessories.

**Gross Vehicle Weight Rating (GVWR):** GVWR means the maximum permissible weight of the trailer, including the UWV plus passengers, personal items, all cargo, fluids, options, and dealer-installed accessories. The GVWR is equal to or greater than the sum of the UWV and the CCC.



From RV insurance to extended warranties, JayPlus has it covered. Ask your Jayco dealer about our exclusive JayPlus program today.

**Cargo Carrying Capacity (CCC):** CCC means the maximum weight of all passengers, personal items, food, fresh water, propane, tools, other cargo and dealer-installed accessories that can be carried by the trailer. CCC is equal to or less than GVWR minus UWV. The addition of options will decrease the CCC.

**Hitch Weight (HW):** The hitch weight, as used in product literature and other promotional materials, does not include cargo, fresh water, propane gas, options or dealer-installed accessories. The addition of these types of items will either add to or subtract from the stated hitch weight.



Travel worry-free with Jayco's Customer First Roadside Assistance program, yours at no cost during your first year of ownership. This program is offered through Coach-Net, the largest RV emergency road service in the country, and gives you immediate access to dependable roadside assistance and support services with a simple phone call.



As a Jayco owner, you can be part of the Jayco Jafari International Travel Club. Ask your dealer about the Jafari "flight" in your area, write Jayco or visit our website.

It is important for your safety and enjoyment that your tow vehicle be adequately sized and equipped to tow and handle the GVWR of the RV you select. Review weights and rating of your tow vehicle and consult a competent advisor for questions or advice. Whether you are new to RVing or a veteran, get a feel for the performance of your tow vehicle before heading out on the roadways. When you tow an RV, you must drive differently than when you drive a single vehicle. Practice hooking up, driving, backing up and braking in a safe environment or seek out professional instruction. Jayco affixes a weight label to each RV which lists weight information for that vehicle. See specifications chart inside.

Jayco, Inc., P.O. Box 460, Middlebury, IN 46540, [www.jayco.com](http://www.jayco.com)

See dealer for further information and prices. All information in this brochure is the latest available at the time of publication approval. Jayco reserves the right to make changes and to discontinue models without notice or obligation. Photos in this brochure may show optional equipment and props for photography purposes. RVs built for sale in Canada may differ to conform to Canadian codes. ©2012 Jayco, Inc. 13-FDCT-PL 1212-30K. Printed in U.S.A.