

WHITE HAWK ULTRA LITE

live large TOW SMALL.





chil N' stor

OUTDOOR STORAGE

The Chil N' Stor is equipped with a standard 1.7 cu. ft. exterior refrigerator.

**INDOORS+OUT
KITCHEN**

The optional Indoors-Out kitchen packs a refrigerator, two-burner stove and sink.

**TRACKER
WIDEAXLES**

An innovative axle design distributes weight more evenly for a smooth ride.



YOU WANT PEACE OF MIND

That's why we offer our exclusive 2-year Co-Pilot Warranty, the industry's best and most comprehensive warranty program.

good things do come in
SMALL PACKAGES

Say hello to the **JAYCO WHITE HAWK**. Your truck will think she's small, but your family will think differently. Big on space, thanks to 36" deep slideouts, and big on amenities, like expansive MaxView windows and standard premium paint, you'll forget you're in a travel trailer. From towing to teardown—and everything in between—you'll enjoy every minute of your getaway.

* Consult with your authorized automobile manufacturer or vehicle owner's manual.

MAXVIEW
WINDOW

The view is twice as nice in a White Hawk thanks to large 60" or 70" dinette windows.

MAGNUMROOF SYSTEM
BY JAYCO

An exclusive Jayco design, our roof system is 50% stronger than other industry roofs.

ELITE  **KITCHEN**

The Elite Kitchen features Amish-crafted cabinetry, halogen lighting and backsplash.

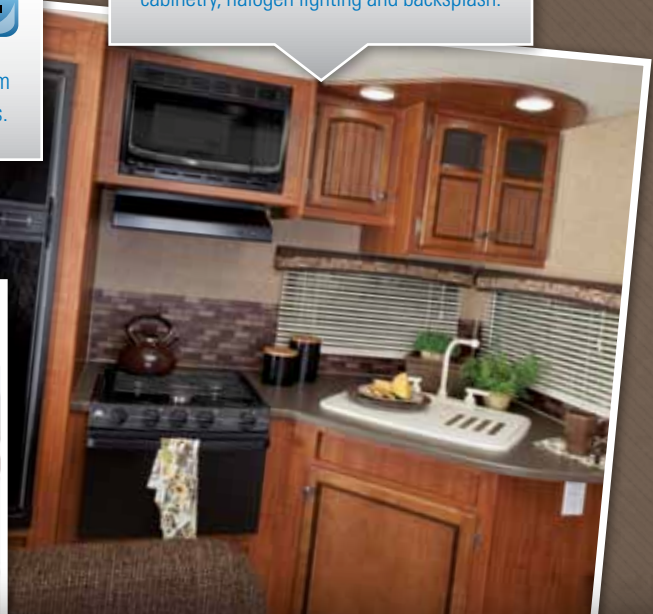

WITH YOUR PURCHASE.

Every Jayco RV undergoes rigorous quality control testing before it leaves the factory, so you can be confident your new Jayco will continue to provide the ultimate in reliability for years to come.

For a copy of our 2-year limited warranty with full terms and conditions, ask your local Jayco dealer.



TO LEARN MORE ABOUT
OUR QUALITY CONTROL
TESTING, SCAN HERE WITH
YOUR SMARTPHONE.



WHITE HAWK TRAVEL TRAILERS

twice the *expandable space*

Thanks to 36" deep slideouts, White Hawk is the roomiest travel trailer on the lightweight market, boasting twice the expandable living space of standard lightweights. Innovative floorplans maximize the expandable design, while thoughtful details, like the Elite Kitchen and family-friendly bunks, equip you for your every camping need.



WHITE HAWK 26SRK | HAZELNUT



WHITE HAWK 26SRK | HAZELNUT



WHITE HAWK 26SRK | HAZELNUT

SMART DESIGN

Maximize space with roomy pantries, a messaging/charging center and stylish, functional dinettes with rounded-access cabinet doors.

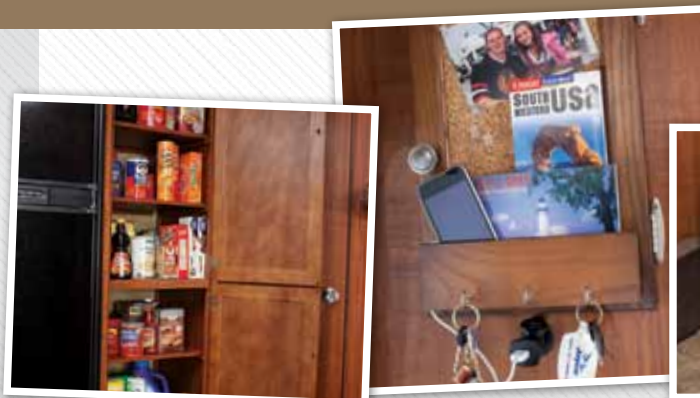

a *reputation* for quality CONSTRUCTION

At Jayco, we've built a reputation for superior construction and quality craftsmanship. We pride ourselves on always using top-quality materials and innovative manufacturing techniques. That commitment has led to our latest construction advancement, the all-new exclusive Magnum Roof System, 50 percent stronger than other roofs in the industry, built to outlast everything but your memories.



OUR NEW ROOF FEATURES ...

- 1 4 1/2" crowned wood trusses: Uses 2"x 2" vertical studs to maximize load capacity, while oversized nail plates provide a tighter design
- 2 3/8" roof decking, screwed down at every seam: More durable than typical stapled construction, provides fully walkable roof
- 3 Residential attic-style insulation: Maintains interior temperatures while allowing for room to run wiring, reducing risky electrical shorts
- 4 One-piece, sidewall-wrapped Alpha Ply material: Provides better leak protection



WALL CONSTRUCTION

- 5 Vacuum-bonded layers: Involves 15-18 minutes of 144 tons of pressure to ensure a strong bond
- 6 Welded aluminum frames with metal backers: Lighter than wood, increases towability
- 7 Bead-foam insulation: Maintains temperatures
- 8 Extra-wide corner seals: Prevents leaks on the corner molds, baggage/entrance doors and window seals
- 9 Innovative, aerodynamic front profile: Eliminates angled profile, increasing towability

FLOOR CONSTRUCTION

- 10 Vacuum-bonded layers: Backed by computer monitoring and constant quality control checks, Jayco prides itself on building a solid foundation
- 11 Bead-foam insulation: Maintains temperatures
- 12 I-Class structural I-beam frame: One-piece design, provides more durability than a welded three-piece frame
- 13 Innovative A-frame: Fully integrated, and not welded, prevents buckling

STANDARDS AND OPTIONS

STANDARD EXTERIOR EQUIPMENT

Deluxe Graphics Package with Mocha paint-infused fiberglass front wall, back wall and 12" sidewall color band
TuffShell vacuum-bonded laminated sidewalls, front walls, floors
Magnum truss roof system with one-piece seamless Alpha Ply
Fully enclosed underbelly
Patio awning
Marine-grade outside speakers (2)
G20 dark-tinted windows
Radial tires
Wide-stance Tracker axles
E-Z Lube axles
Galvanized-steel, impact-resistant wheel wells
Aerodynamic, rounded front profile
Front diamond plate
Completely enclosed and protected electric slide mechanisms
Chil N' Stor outside baggage compartment with 1.7 cu. ft. exterior refrigerator
Utility Lighting System: Entrance step, baggage compartment, hitch and dump station light
Stabilizer jacks with sand pads (4)
30-amp power service
Dual 20-lb. propane bottles with auto regulator

STANDARD INTERIOR EQUIPMENT

Elite Kitchen: Overhead cabinetry with etched-glass and bead-board inserts; large, rounded countertops; deep bowl, 60/40 acrylic sink with high-rise faucet; 6.3 cu. ft. Norcold refrigerator with magnet-friendly panels; 3-burner range with 9,000-BTU SuperBurner with piezo igniter; 12" decorative backsplash; decorative ceiling feature; recessed halogen lights
Ball bearing drawer guides, 75-lb. capacity with full-drawer extension throughout
Plywood dinette, bunk and bed bases
Large MaxView tinted safety-glass dinette window (60" on standard dinettes, 70" on U-dinettes)
Diamondflor vinyl flooring
Wood-grain accent paneling on select interior walls
Rounded, residential J-Steel jack-knife sofa
High-output Atwood auto ignition furnace with wall thermostat
Directional/closeable central A/C vents
AM/FM/CD home theatre-style DVD player
Full-height shirt wardrobes in front walk-around queen bedroom models

CUSTOMER VALUE PACKAGE (MANDATORY)

ABS propane bottle cover
Outside shower
Spare tire and carrier
13,500-BTU A/C
Microwave with built-in range hood and light
Oven
6 gal. gas/electric DSI water heater
Bath skylight
Tub surround

OPTIONS

Glacier Package
Aluminum rims
Adjustable-pitch electric awning
Indoors-Out Camp Kitchen: Sink, stove and secondary manual kitchen awning (26DSRB, 29SQB, 31DSLb)
Indoors-Out Camp Kitchen: Sink, stove and secondary power kitchen awning (26DSRB, 29SQB, 31DSLb)
Outside bumper-mount grill
Power stabilizer jacks
Power tongue jack
Roof ladder
Customer Value Package
Customer Value Package with 15,000-BTU A/C
26" LED HDTV
Free-standing table with 4 chairs (select models)
Hide-a-bed sofa (select models)
Ledgestone fireplace with 32" LED TV (30DSRE)

eco advantage™

THE JAYCO ECOADVANTAGE IS OUR COMPANY'S COMMITMENT TO PROTECTING THE ENVIRONMENT. Scan this QR code with your smartphone to watch a video about our efforts and the impact we're having on our world.

www.jayco.com/ecoadvantage



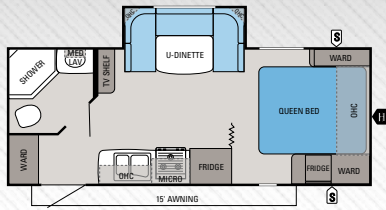

WHITE HAWK | 21DSRB

Ext. Lgth: TBD Ext. Ht: TBD Unloaded Wt (lbs.): TBD Sleeps: 3-4

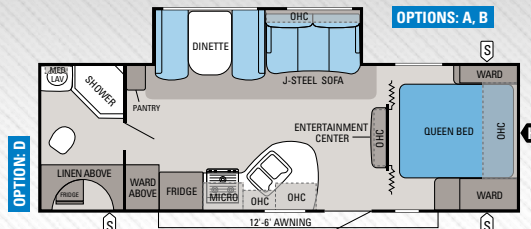

WHITE HAWK | 26DSRB

Ext. Lgth: 29' 11" Ext. Ht: 128" Unloaded Wt (lbs.): 5,040 Sleeps: 3-6

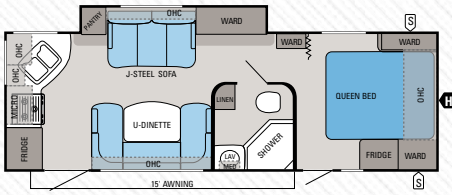

WHITE HAWK | 26SRK

Ext. Lgth: 28' 11" Ext. Ht: 128" Unloaded Wt (lbs.): 5,015 Sleeps: 4-6

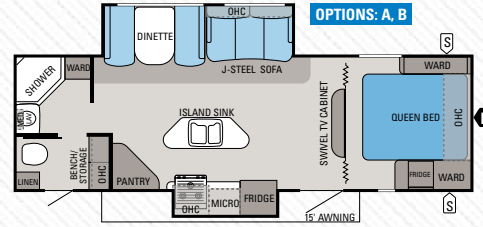

WHITE HAWK | 27DSRB

Ext. Lgth: 30' 11" Ext. Ht: 130" Unloaded Wt (lbs.): 5,615 Sleeps: 3-6

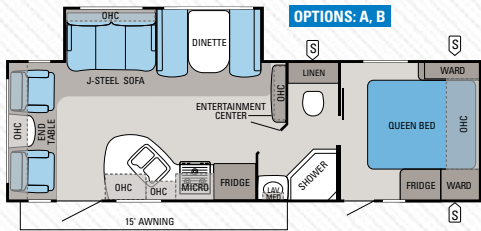

WHITE HAWK | 27DSRL

Ext. Lgth: 30' 11" Ext. Ht: 128" Unloaded Wt (lbs.): 5,400 Sleeps: 3-6

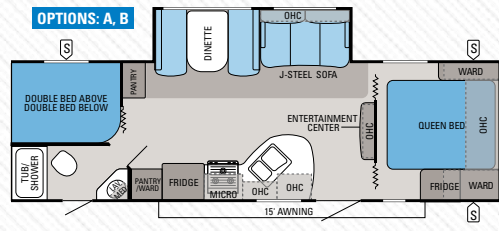

WHITE HAWK | 28DSRB

Ext. Lgth: 31' 11" Ext. Ht: 128" Unloaded Wt (lbs.): 5,290 Sleeps: 7-10

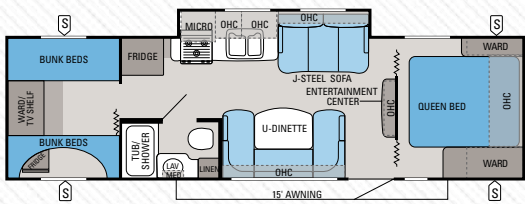

WHITE HAWK | 29SQB

Ext. Lgth: 32' 11" Ext. Ht: 127" Unloaded Wt (lbs.): 5,370 Sleeps: 9-10

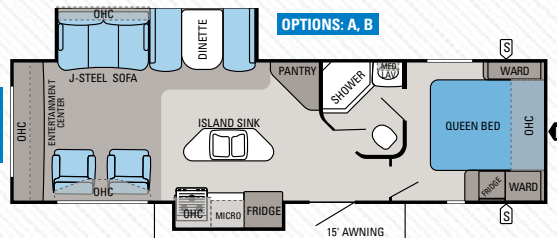

WHITE HAWK | 30DSRE

Ext. Lgth: 33' 11" Ext. Ht: 131" Unloaded Wt (lbs.): 5,990 Sleeps: 3-6

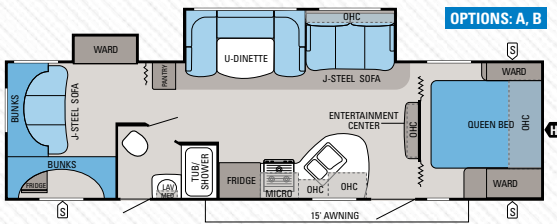

WHITE HAWK | 31DSL B

Ext. Lgth: 34' 11" Ext. Ht: 131" Unloaded Wt (lbs.): 6,125 Sleeps: 6-10

OPTIONS

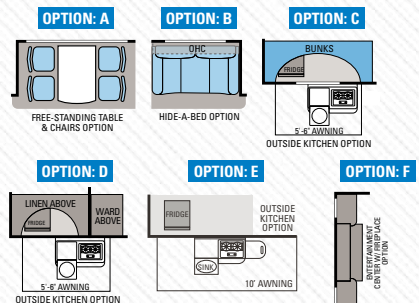

WOOD

DÉCOR CHOICES

HAZELNUT

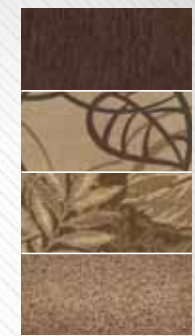

BROWNSTONE

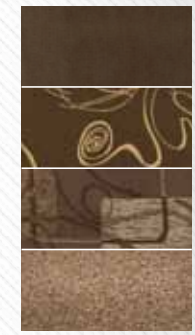

AMARETTO

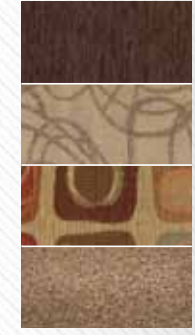

BRICK



SPECIFICATIONS

FLOORPLAN	EXTERIOR LENGTH	EXTERIOR WIDTH	EXTERIOR HEIGHT (WITH A/C)	INTERIOR HEIGHT	UNLOADED VEHICLE WEIGHT (LBS.)	DRY HITCH WEIGHT (LBS.)	GROSS VEHICLE WEIGHT RATING (LBS.)	CARGO CARRYING CAPACITY (LBS.)	FRESH WATER CAPACITY (GAL) (WITH WATER HEATER)	GRAY WASTEWATER CAPACITY (GAL.)	TOILET/BLACK WASTEWATER CAPACITY (GAL.)
21DSRB	TBD	96"	TBD	78"	TBD	TBD	TBD	TBD	46.2	30.5	30.5
26DSRB	29' 11"	96"	128"	78"	5,040	535	7,250	2,210	46.2	30.5	30.5
26SRK	28' 11"	96"	128"	78"	5,015	665	6,950	1,935	46.2	45	30.5
27DSRB	30' 11"	96"	130"	78"	5,615	630	7,750	2,135	46.2	53	30.5
27DSRL	30' 11"	96"	128"	78"	5,400	610	7,500	2,100	46.2	30.5	30.5
28DSRB	31' 11"	96"	128"	78"	5,290	590	7,500	2,210	46.2	45	30.5
29SQB	32' 11"	96"	127"	78"	5,370	540	7,500	2,130	46.2	30.5	30.5
30DSRE	33' 11"	96"	131"	78"	5,990	585	8,200	2,210	46.2	30.5	30.5
31DSL B	34' 11"	96"	131"	78"	6,125	630	8,200	2,075	46.2	45	30.5

The weights of certain options and/or option packages are not included in the UWW listed above.



THE **Jayco**[®] family STORY

THE JAYCO STORY BEGAN IN 1968 WITH OUR FAMILY—THE BONTRAGERS. Lloyd Bontrager created an innovative, easy-to-use lifter system that led to a better fold-down camper. Loaded with more conveniences, he believed his camper would bring families closer together.

Since then, the Jayco family has grown. From our factory to our front office, from our salespeople to our suppliers, our family bond is four decades strong with the support of more than 300 Jayco dealers.

Together, we're helping make new family stories. **YOUR FAMILY STORY.**

welcome to the **Jayco family**



Establishing a solid relationship with your local Jayco dealer is a key component in the enjoyment of your new Jayco. By purchasing from a local dealer, you will have a convenient location for sales, parts and service support. We hope you enjoy working with them as much as we do.



Jayco proudly sponsors Tread Lightly!, a nonprofit organization whose mission is to empower generations to enjoy the outdoors responsibly through education and restoration.

Unloaded Vehicle Weight (UWV): Sometimes referred to as "Dry Weight," UWV means the typical weight of this trailer as built at the factory. The UWV, as used in product literature and other promotional materials, does not include cargo, fresh water, propane, options or dealer-installed accessories.

Gross Vehicle Weight Rating (GVWR): GVWR means the maximum permissible weight of the trailer, including the UWV plus passengers, personal items, all cargo, fluids, options, and dealer-installed accessories. The GVWR is equal to or greater than the sum of the UWV and the CCC.



From RV insurance to extended warranties, JayPlus has it covered. Ask your Jayco dealer about our exclusive JayPlus program today.

Cargo Carrying Capacity (CCC): CCC means the maximum weight of all passengers, personal items, food, fresh water, propane, tools, other cargo and dealer-installed accessories that can be carried by the trailer. CCC is equal to or less than GVWR minus UWV. The addition of options will decrease the CCC.

Hitch Weight (HW): The hitch weight, as used in product literature and other promotional materials, does not include cargo, fresh water, propane gas, options or dealer-installed accessories. The addition of these types of items will either add to or subtract from the stated hitch weight.



Travel worry-free with Jayco's Customer First Roadside Assistance program, yours at no cost during your first year of ownership. This program is offered through Coach-Net, the largest RV emergency road service in the country, and gives you immediate access to dependable roadside assistance and support services with a simple phone call.



As a Jayco owner, you can be part of the Jayco Jafari International Travel Club. Ask your dealer about the Jafari "flight" in your area, write Jayco or visit our website.

It is important for your safety and enjoyment that your tow vehicle be adequately sized and equipped to tow and handle the GVWR of the RV you select. Review weights and rating of your tow vehicle and consult a competent advisor for questions or advice. Whether you are new to RVing or a veteran, get a feel for the performance of your tow vehicle before heading out on the roadways. When you tow an RV, you must drive differently than when you drive a single vehicle. Practice hooking up, driving, backing up and braking in a safe environment or seek out professional instruction. Jayco affixes a weight label to each RV which lists weight information for that vehicle. See specifications chart inside.

Jayco, Inc., P.O. Box 460, Middlebury, IN 46540, www.jayco.com

See dealer for further information and prices. All information in this brochure is the latest available at the time of publication approval. Jayco reserves the right to make changes and to discontinue models without notice or obligation. Photos in this brochure may show optional equipment and props for photography purposes. RVs built for sale in Canada may differ to conform to Canadian codes. ©2012 Jayco, Inc. 13-WTHK-PL 0113-40K Printed in U.S.A.