

FEATURE LEADER

2012

GREYHAWK



GREYHAWK® | MOTORHOMES BY JAYCO®

AMERICA'S MOST LIVEABLE RV'S.



GREYHAWK | MOTORHOMES



FEATURE
LEADER



GREYHAWK 31FK | CRIMSON



GREYHAWK 31DS | WALNUT



GREYHAWK 31DS | WALNUT



GREYHAWK 31DS | WALNUT

AHEAD OF ITS CLASS

Built on a Ford E-450 chassis with a 305 HP Triton engine, the 2012 Jayco Greyhawk provides the power and control you want in a Class C motorhome, while solid real-wood cabinetry, weathered iron bronze hardware, Cloud Ten pillowtop mattress and residential-style furniture deliver the comfort you demand. Greyhawk delivers the best value on the road today, with more high-end features and amenities than anything in its price range.



NOBODY OFFERS A BETTER WARRANTY THAN WE DO

YOU WANT YOUR RV TO LAST A LONG TIME.

That's why we offer our exclusive 2-year Co-Pilot Warranty, the best and most comprehensive warranty program in the industry. Every Jayco RV undergoes rigorous quality control testing before it leaves the factory, so you can be confident your new Jayco will continue to provide the ultimate in liveability and reliability for years to come.

For a copy of our 2-year limited warranty with full terms and conditions, ask your local Jayco dealer.

ROADSIDE ASSISTANCE

Travel worry-free with Jayco's Customer First Roadside Assistance program, yours at no cost during your first year of ownership. This program is offered through National Motor Club, the largest RV emergency road service in the country, and gives you immediate access to dependable roadside assistance and support services with a simple phone call.



TO LEARN MORE ABOUT OUR QUALITY CONTROL TESTING, SCAN HERE WITH YOUR SMARTPHONE.



TRUE VALUE OF OWNERSHIP

↑ MORE STANDARD FEATURES

We pack more standard features into our RVs than anyone else. Even better, they're features we know you'll want, designed to make your motorhome more home-like, comfortable and convenient. Because at Jayco, it's always been about liveability.

↑ BRAND-NAME COMPONENTS

We like living up to the name we've built for ourselves. That's why we only use dependable components in our RVs, made by companies that value their reputation as much as we do ours.

↑ LESS MAINTENANCE

Our top-quality materials and production techniques let you spend more time enjoying your new RV and less time maintaining it.

↑ BETTER AVERAGE RESALE VALUE

In the last three years, Jayco owners have been banking on their investments. According to the NADA, Jayco's average resale value was 4.81% higher than the competition, giving Jayco the top resale value in the RV industry.

With Jayco, you get more amenities, more liveable, home-like features and superior construction for less maintenance and greater resale value. **Simply put, you won't find another RV packed with more TRUE VALUE.**



SETTING THE BAR FOR PERFORMANCE

At Jayco, we believe in making our motorhomes well-oiled machines, so we don't skimp on standards that give you power. With Greyhawk's **A** | Triton 6.8L EFI V-10 305 HP engine with power anti-lock brakes and power steering and **B** | a Ford E-450 chassis with a five-speed TorqShift automatic transmission, Greyhawk can effortlessly tow up to 5,000 pounds. And with **C** | a lap belt built in to every seating position, it'll be a safe ride.

HIGH-END FEATURES

Greyhawk offers up top-notch names with its **A** | standard, fuel-efficient Onan 4,000-watt generator (usually optional on other motorhomes), **B** | optional Sirius satellite radio with over 180 channels to choose from and **C** | an Optima leather driver seat with six-way power.



MORE CONVENIENT

We want you to be able to enjoy your trip. To do that, we've taken the maintenance out of features you use every day. With Greyhawk's **A** | accessible mega pass-through storage, **B** | electric-powered, swing-away, remote-controlled and heated side-view mirrors and **C** | optional hydraulic automatic leveling jacks, camping just got a lot easier.



LONG-LASTING QUALITY CONSTRUCTION

Known for quality construction, Jayco is built to hold its value for many years thanks to features like **A** | optional aluminum alloy wheels, built to handle whatever the road throws at it, and **B** | a front cap, seamlessly engineered to reduce leaks and aerodynamically designed to increase gas mileage.

JAYCO CONSTRUCTION

At Jayco, we've built a reputation for superior construction and craftsmanship. We always use top-quality materials and innovative manufacturing techniques—down to the smallest details. The result? Unmatched resale value and peace of mind in an RV that's built to handle whatever the road throws at it, while outlasting everything but your memories.



BALL BEARING GUIDES

Our residential-style ball bearing drawer guides provide smooth operation and full-drawer extension for a stronger, more substantial drawer and a home-like feel.



OLD WORLD CRAFTSMANSHIP

Jayco's dedicated production team includes Amish craftsmen who build with well-honed woodworking techniques passed down for generations.



All Jayco products are green certified. Greyhawk earned a gold rating through use of sustainable materials, environmentally friendly production methods and reduction of waste.

WALL CONSTRUCTION

- 1 Vacuum-bonded layers:** Involves 15-18 minutes of 144 tons of pressure to ensure a stronger bond
- 2 High-gloss, gel-coated HG 4000 fiberglass exterior and optional Diamond Shield paint protection:** Withstands use, travel and UV rays while creating a stunning package
- 3 Seamless front cap:** Increases aerodynamics, while cap adds durability and leak protection where it's needed most

FLOOR CONSTRUCTION

- 4 Vacuum-bonded layers:** Backed by computer monitoring and constant quality control checks, Jayco prides itself on building a solid foundation
- 5 Welded aluminum frame:** Lighter than wood, increases Greyhawk's maneuverability
- 6 Structurwood floors:** Creates one of the industry's strongest foundations

ROOF CONSTRUCTION

- 7 Vacuum-bonded layers:** Laminates materials together using more pressure than typical pinch-roll process
- 8 Bead-foam insulation (R-15) and padded ceiling:** Maintains interior temperatures, absorbs sounds
- 9 1/4" plywood decking on 5" arched welded aluminum trusses:** More moisture resistant, plywood holds up to the elements
- 10 Seamless fiberglass shield:** Features one-piece construction, ensuring better leak protection

PERFORMANCE

- 11 Ford E-450 chassis and Triton 6.8L V-10 305 HP engine:** Features 19,500 lbs. GCWR with up to 5,000 lbs. of towing capacity
- 12 MOR/ryde frame:** Extends chassis for optimal weight distribution and features durable design with one-piece assembly, laser-shear, tight-fit construction and consistent, robotically-welded structure
- 13 Rubber body mounts with Hellwig helper springs:** Reduces vibration

STANDARDS AND OPTIONS

STANDARD INTERIOR EQUIPMENT

- 3-burner range with 9,000-BTU SuperBurner and piezo igniter
- 8-cu. ft. flush-mount refrigerator with double door
- 15,000-BTU ducted A/C
- ABS shower with one-piece surround
- Auto-ignition furnace with wall thermostat
- Ball bearing drawer guides, 75-lb. capacity with full-drawer extension
- Cable TV hookup with RG6 coax
- Crank-up digital antenna with signal booster
- Cutting board cover for sink
- ↑ Dream Dinette mechanism, raises and lowers dinette tabletop
- Interior Command Center
- J-Steel sofa
- ↑ Lap safety belts on all living area seats
- Large wardrobes
- Marine toilet with foot flush
- Microwave oven with carousel
- Overhead cabinet with LCD HDTV (select models)
- Oversized oven
- ↑ Queen-sized bed with Cloud Ten pillowtop mattress
- Raised-panel cabinet doors throughout
- Residential furniture, designed and made by Jayco
- Satellite dish prep for roof and sidewall
- Under-bed storage, bed lifts easily on gas struts (select models)
- ↑ Washington Glazed Maple cabinetry
- Water purification system
- White, residential-style, double-bowl kitchen sink and single-lever faucet with pull-out sprayer

STANDARD EXTERIOR EQUIPMENT

- 12V electrical system with 120V, 60-amp power converter
- 30-amp power cord
- 56-lb. chassis-mounted propane gas tank
- 80" tall fiberglass, radius-cornered entrance and screen door
- Black holding tank sprayer

Carefree Travel'r 12V electric patio awning with adjustable pitch

- ↑ Front molded seamless fiberglass cap
- ↑ FRP Lamilux 4000 smooth fiberglass sidewall exteriors
- ↑ Heated holding tanks, 12V pads
- High-output, marine-grade exterior speakers (2)
- ↑ Onan 4,000-watt MicroQuiet generator with auto-changeover
- ↑ Pass-through storage compartment with slam latches and light (select models)
- Screwed-stile cabinetry construction
- Seamless one-piece rubber roof
- Slideout battery tray
- Tinted safety-glass windows
- ↑ TuffShell vacuum-bonded 5" crowned laminated roof
- ↑ TuffShell vacuum-bonded laminated roof, floor and sidewalls
- Undercoating
- Unitized, 1-1/2" laminated floor construction
- Water heater bypass system
- Welded tubular-aluminum sidewall framework

STANDARD CAB EQUIPMENT

- 3-point lap and shoulder safety belts (driver and passenger)
- Auxiliary start switch
- Driver and passenger air bags
- Padded fabric headliner
- ↑ Power, Optima leather driver-side seat
- Privacy curtains for cab area
- ↑ Remote keyless entry

STANDARD CHASSIS EQUIPMENT

- 5-speed automatic TorqShift series transmission with overdrive 55-gal. fuel tank
- 130-amp alternator
- 5,000-lb. hitch with 7-pin plug
- A/C and cruise control from factory
- ↑ Hellwig helper springs
- Power anti-lock brakes with power steering
- ↑ Triton 6.8L EFI V-10 305 HP engine

OPTIONS

- 22" LCD HDTV in bedroom
- 400-watt inverter
- Aluminum rims
- Bunk CD/DVD players (2) (31FS)
- Diamond Shield paint protection film
- Driver/passenger side view cameras
- Front entertainment center with 32" LCD HDTV
- Hide-a-bed sofa in lieu of dinette (26DS)
- Hydraulic auto leveling jacks
- In-motion satellite dish
- Navigation system
- On-demand tankless water heater
- Premium Paint Package: Amber Stone
- Satellite kit includes tripod, dish and A/V cables
- Sirius satellite radio system

CUSTOMER VALUE PACKAGE

- AM/FM/CD/DVD with back-up camera monitor
- Attic fan
- Bathroom power vent
- ↑ Clarion infotainment system with in-dash, touch-screen radio with 6.5" LCD color display, DVD/USB, Sirius satellite prep and Bluetooth
- Day/night shades throughout
- ↑ Deluxe, remote-control, heated, side-view mirrors
- Glass shower door
- Portable, outside gas grill
- Wood-grain dash kit



FOR A COMPLETE LIST OF STANDARDS AND OPTIONS, SCAN HERE WITH YOUR SMARTPHONE OR VISIT JAYCO.COM.

FLOORPLANS

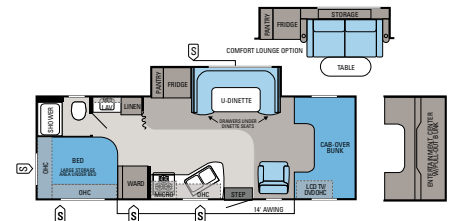

GREYHAWK | 26DS

Ext. Length: 28' 9" Exterior Height: 136" Sleeps: 4-5

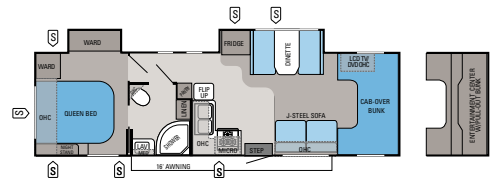

GREYHAWK | 31DS

Ext. Length: 32' 3" Exterior Height: 136" Sleeps: 5-7

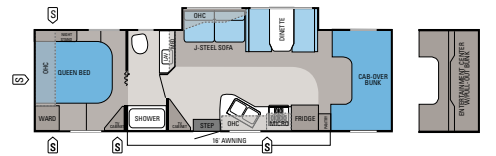

GREYHAWK | 31FK

Ext. Length: 32' 3" Exterior Height: 136" Sleeps: 5-7

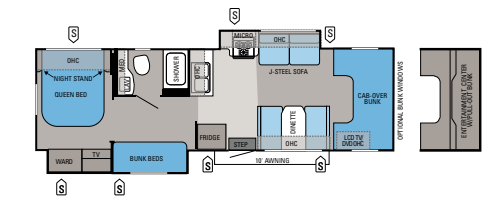

GREYHAWK | 31FS

Ext. Length: 32' 3" Exterior Height: 136" Sleeps: 7-9

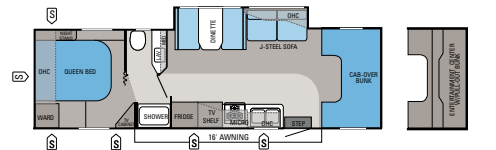

GREYHAWK | 31SS

Ext. Length: 31' 9" Exterior Height: 136" Sleeps: 5-7

- S OUTSIDE STORAGE
- H TRAILER HITCH
- LAV BATHROOM SINK
- MICRO MICROWAVE
- OHC OVERHEAD CABINETS
- FRIDGE REFRIGERATOR
- WARD WARDROBE

EXTERIOR PAINT CHOICES



STANDARD PAINT PACKAGE



AMBER STONE PREMIUM PAINT (OPTIONAL)

INTERIOR DÉCOR CHOICES

CRIMSON



WALNUT



NUTMEG



WOOD



SPECIFICATIONS

| FLOORPLAN | EXT. LENGTH | EXT. WIDTH | EXT. HEIGHT (WITH A/C) | INT. HEIGHT | GROSS VEHICLE WEIGHT RATING (LBS.) | GROSS COMBINED WEIGHT RATING (LBS.) | ENGINE/SIZE | WHEEL BASE | FURNACE AUTO-IGNITION (BTUS) | FRESH WATER CAPACITY (INCLUDES WATER HEATER) (GALS.) | GRAY WASTE WATER CAPACITY (GALS.) | BLACK WASTE WATER CAPACITY (GALS.) |
|-----------|-------------|------------|------------------------|-------------|------------------------------------|-------------------------------------|---------------------|------------|------------------------------|--|-----------------------------------|------------------------------------|
| 26DS | 28' 9" | 100" | 136" | 84" | 14,500 | 19,500 | 6.8L TRITON EFI V10 | 181" | 31M | 39 | 41 | 33 |
| 31DS | 32' 3" | 100" | 136" | 84" | 14,500 | 19,500 | 6.8L TRITON EFI V10 | 223" | 31M | 39 | 41 | 31 |
| 31FK | 32' 3" | 100" | 136" | 84" | 14,500 | 19,500 | 6.8L TRITON EFI V10 | 223" | 31M | 39 | 41 | 32 |
| 31FS | 32' 3" | 100" | 136" | 84" | 14,500 | 19,500 | 6.8L TRITON EFI V10 | 223" | 31M | 39 | 44 | 32 |
| 31SS | 31' 9" | 100" | 136" | 84" | 14,500 | 19,500 | 6.8L TRITON EFI V10 | 218" | 31M | 39 | 41 | 32 |

A TRADITION OF LIVEABILITY

THE JAYCO STORY BEGAN IN 1968 when Jayco founder Lloyd Bontrager created an innovative, easy-to-use lifter system that led to a better fold-down camper. Loaded with more comforts and conveniences, Lloyd believed his camper would bring people closer together because it was more liveable. A devoted family man, Lloyd's passion extended to his business as well. In fact, our company's success stems from his insistence on treating everyone at Jayco as family — from our factory to our front office, our salespeople to our suppliers, and our customers to our community.

BLENDING OLD WORLD AMISH CRAFTSMANSHIP WITH INNOVATIVE TECHNOLOGY, Jayco is the nation's largest family-owned and operated RV manufacturer today. And while our product line has grown considerably over the years, every unit we build is still guided by Lloyd's vision and a humble desire to help make it easier for families to explore together and relax together. It's what separates us from other RV manufacturers. And it's what continues to make Jayco America's Most Liveable RVs.



AMERICA'S MOST **LIVEABLE** RVs.



Jayco proudly sponsors Tread Lightly!, a nonprofit organization whose mission is to empower generations to enjoy the outdoors responsibly through education and restoration.



From RV insurance to extended warranties, JayPlus has it covered. Ask your Jayco dealer about our exclusive JayPlus program today.



As a Jayco owner, you can be part of the Jayco Jafari International Travel Club. Ask your dealer about the Jafari "flight" in your area, write Jayco or visit our website.

Gross Vehicle Weight Rating (GVWR): The maximum permissible weight of the motorhome, including the Unloaded Vehicle Weight (UUV) plus passengers, personal items, all cargo, fluids, options and dealer-installed accessories. The GVWR is equal to or greater than the sum of the UUV and the Cargo Carrying Capacity.

Gross Combined Weight Rating (GCWR): The maximum allowable combined weight of the motorhome used as a tow vehicle and the attached towed vehicle. It is important for your safety and enjoyment that you are aware of the weights and tow ratings of the RV you select. Consult a competent advisor for questions or advice. Whether you are new to RVing or a veteran, get a feel for the performance

of your RV before heading out on the roadways. When you tow a vehicle with your RV, you must drive differently than when you drive a single vehicle. Practice hooking up, driving, backing up and braking in a safe environment or seek out professional instruction. Jayco affixes a weight label to each RV which lists weight information for that vehicle. Refer to that label to verify the vehicle will meet your requirements. See specifications chart inside.

Jayco, Inc., P.O. Box 460, Middlebury, IN 46540, www.jayco.com 

See dealer for further information and prices. All information in this brochure is the latest available at the time of publication approval. Jayco reserves the right to make changes and to discontinue models without notice or obligation. Photos in this brochure may show optional equipment and props for photography purposes. RVs built for sale in Canada may differ to conform to Canadian codes. ©2011 Jayco, Inc. 12-GREY-PL 0711-75K Printed in U.S.A.