

EAGLE™
2006 Fifth Wheels and Travel Trailers

QUALITY IS STANDARD EQUIPMENT.



AMERICA'S MOST LIVEABLE RVS.

2006 FIFTH WHEELS & TRAVEL TRAILERS EAGLE

TRAVEL TRAILERS

2006 Eagle™ by Jayco®

To find out more about America's Most Liveable RVs, visit www.jayco.com



THE NEW STANDARD FOR STANDARD.

We don't think a manufacturer's list of options should be longer than their list of standard features. With every Eagle you get solid oak cabinet doors, pillow-top mattresses on queen beds. Travel trailers get diamond plate rock guards and fifth wheels get adjustable axles ... all standard.



1



2



3

1. Jayco's J-Steel® convertible sofa and dinette provide a relaxing spot to rest your feet after an active day.
2. You'll sleep like a baby on the pillow-top queen mattress covered in a luxurious, quilted bedspread.
3. Diamond plate protects from rocks and road debris. Pass-through storage area easily holds large items.



AMERICA'S MOST LIVEABLE RVs.

"Liveable," to our customers, it could mean comfort. To our designers, it's a refined, ergonomic floorplan. For those who build them, they see value. The definition is most likely "all of the above" ... and then some.

QUALITY IS STANDARD EQUIPMENT



FIFTH WHEELS

2006 Eagle™ by Jayco®

To find out more about America's Most Liveable RVs, visit www.jayco.com

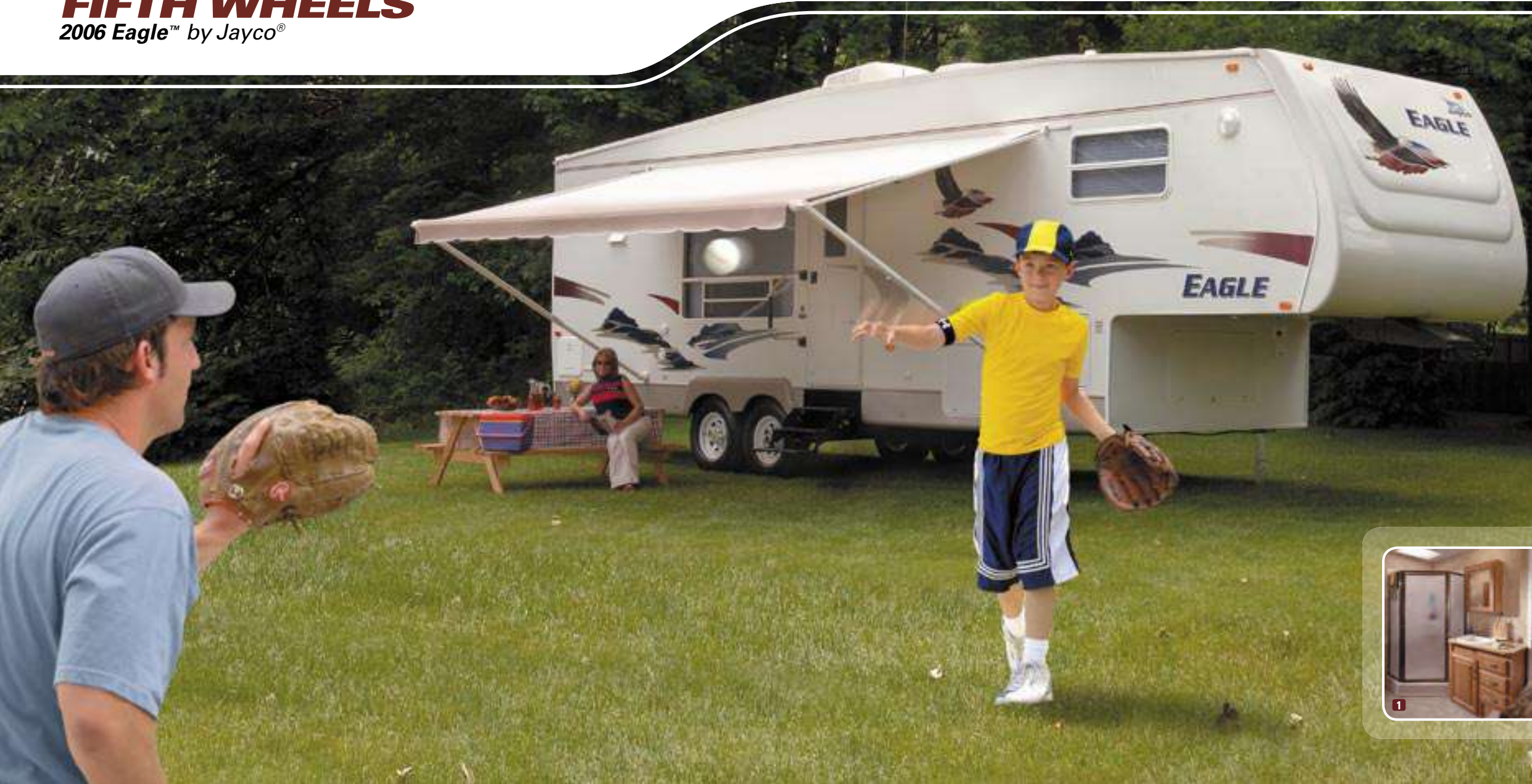

MORE THAN YOU EXPECT.

Take construction for example... vacuum-bonded sidewalls supported by welded aluminum framing. The Eagle chassis uses one-piece structural steel I-beams instead of welded together versions that could warp. Standard on every Eagle travel trailer or fifth wheel are slide-outs running on rack-and-pinion electric drive.



1. Wind down in your residential-style bathroom, complete with a medicine cabinet and mirror, ABS shower with tub surround and glass shower door.
2. The bedroom contains handsome Manchester Oak cabinetry, plush quilted bedspread and cushiony carpet.
3. Jayco combined all of the best kitchen amenities, resulting in the ultimate space for creating meals.

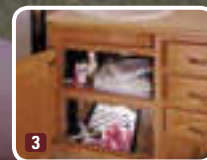

COMFORT IS IN THE DETAILS

1. A spacious front trunk allows you to conveniently store and protect bulky items like coolers and lawn chairs.
2. The Eagle's exterior shower makes rinsing off after outdoor activities easy and keeps the inside of your RV clean.
3. The bathroom's many upscale features include a laundry chute with basket (most fifth wheels).

QUALITY IS STANDARD EQUIPMENT



CONSTRUCTION FEATURES

2006 Eagle™ by Jayco®



Built to Last

Eagle travel trailers and fifth wheels are constructed with the highest quality materials and craftsmanship. So you can hit the road and start making memories without ever having to worry about the performance of your RV.

1. 4½' bowed truss roof rafters
2. Insulated A/C ducting
3. R-11 insulation
4. 3/8" roof decking
5. Filon® fiberglass sidewalls provide a low maintenance and abrasion resistant surface
6. Extra-strong TuffShell™ vacuum-bonded sidewalls are constructed with welded aluminum framing. Everything is anchored to the floor so the floor supports the weight of the walls.
7. Our aluminum framing is welded in jigs.
8. Strong 5/8" tongue-and-groove plywood flooring
9. Puncture-resistant PolyFlex™ lines the underside of the floor. All holding tanks are insulated and heated, and bottoms are wrapped to create a fully enclosed underbelly.
10. R-7 blanket insulation
11. Insulated in-floor ducted heating distributes heat evenly and frees up more space for cabinets.
12. Additional R-7 blanket insulation included in enclosed underbelly
13. 2" x 3" floor studs



Jayco Craftsmanship

Jayco has been blessed with some of America's finest craftsmen who make Middlebury, Indiana and the Jayco plant their home and workplace. Generation after generation, a legacy of tried-and-true construction methods is passed down, continuing the tradition of quality and durability that has helped Jayco grow into a true industry leader.

To find out more about America's Most Liveable RVs, visit www.jayco.com



Standard Jake Plate™

The height of your tow vehicle will never be a worry. Eagle fifth wheels feature standard Jake Plate™ adjustable axle hanger plates. Twice as strong as traditional single spring hangers, they allow you to adjust the axle height up to 2" to accommodate tow vehicles of different sizes.



Aluminum Sidewall Framing

All of our sturdy construction features, including the standard sidewall aluminum framing of our TuffShell™ sidewalls, are there to give you peace of mind.

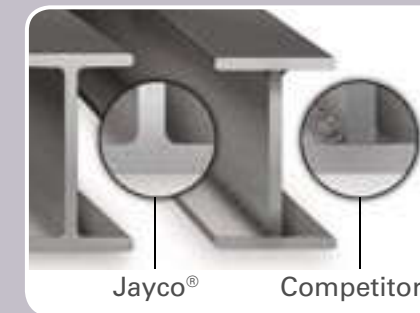

I-Class™ Chassis

Jayco's I-Class™ structural steel chassis frame is stronger and more durable than the welded I-beam used by many competitors, which is subject to warping.



Fiberglass Caps

Our fiberglass caps wrap around the sidewalls, protecting the Eagle from the elements and adding an attractive look.



V-Tec™ Slideout System

Jayco's V-Tec™ slideout expands your living space by the simple push of a button. A strong I-Class™ steel frame allows Jayco to utilize a flush-floor slideout system. Our V-Tec™ mechanism consists of rack-and-pinion drive, low-friction gearing, and high-torque electric motor.

QUALITY IS STANDARD EQUIPMENT



FEATURES

2006 EAGLE by Jayco®

To find out more about America's Most Liveable RVs, visit www.jayco.com

2006 Standard and Optional Features

Standard Living Room Features

- 3 color-coordinated interior choices
- Antique brass combination cabinet hardware
- Antique brass lighting at sofa and dinette
- Cable TV hookup
- Cable and satellite TV prepped
- Crank-up TV antenna w/signal booster
- Day/night shades throughout
- Fabric-covered box valances with lambrequin legs
- Hide-a-bed sofa with foot rest
- High-intensity 12V lighting package
- Linoleum entryway
- Manchester Oak raised-paneled doors and drawers
- Oak interior grab handle main entrance door
- Oak trim around main entrance door
- Overhead cabinets in slideout room
- Slider windows on slideout end walls
- Swivel rocker(s) (select models)
- Trackless carpeting w/pad
- TV overhead cabinet
- Solid hardwood interior handle for entry assistance

Standard Bathroom Features

- ABS tub/shower surround
- Glass shower door
- Laundry chute with basket
- Marine toilet
- Medicine cabinet w/mirror
- Switches for all lights
- Towel holder

Standard Kitchen Features

- 3-burner range w/9,000-BTU SuperBurner™ and piezo igniter
- 8 cu. ft. flush-mounted refrigerator with double door
- Bi-fold cover for range
- Color-coordinated countertops
- Deep residential-style sink
- Extra-long silverware drawer

- Drawer for silverware, divided for utensils
- Large dinette picture window
- Oversized oven
- Range hood with light and fan
- Residential-style white arched neck faucet
- Sink cover/cutting board (1)
- Antique brass high-rise faucet

Standard Bedroom Features

- Accordion door to bedroom (select models)
- Bed lifts up on easily on struts, storage below
- Carpet and pad
- Coordinated, quilted bedspread
- Large pass-through storage (select models)
- TV cabinet or flip-up TV shelf (select models)

Standard Heat, Power and Water Features

- 110V G.F.C.I. protected exterior receptacle
- 12V demand water pump
- 12V electrical system w/deluxe 110V, 45-amp. power converter
- 30-amp. power cord
- Auto-ignition furnace w/thermostat
- Cable and satellite TV prepped
- Double 30-lb. LP gas tanks with regulator
- Hook-up for city water
- In-floor ducted heating
- Outside shower
- Systems monitor panel
- Water heater bypass system
- Water system winterization kit

Standard Exterior Features

- 12V hitch light
- 16" radial tires
- 15" radial tires
- ABS fender skirts
- Baggage doors, lockable, insulated and radius-cornered w/heavy-duty handles

- Bumper w/drain hose carrier and end caps
- Champagne-colored radius skirting
- Chrome hub caps
- Electric powered front jacks
- E-Z lube® axles
- Galvanized steel wheel wells
- Patio light w/inside switch
- Rain guttering, molded with drip spouts
- Rear stabilizer jacks (2)
- Retractable triple entrance step
- Screened egress bunk windows
- Snap jacks
- White-framed radius fiberglass main entry door
- Cover for LP gas bottle made of molded ABS
- Diamond-plated panel on front
- Front window includes fiberglass stoneguard

Standard Construction Features

- 2"x3" longitudinal floor studs placed on 16" centers
- 4 1/2" arched truss roof rafters
- 5'8" tongue and groove plywood main floor decking
- Aerodynamic wrap around front fiberglass cap
- Bead-foam insulation in sidewalls (R-9)
- Cabinetry crafted with screwed stile construction
- Electric-powered slideout
- Enclosed, insulated and heated underbelly
- Filon® fiberglass sidewall exteriors
- Pin box, long
- Platforms for dinette, bed and bunks are constructed of 1/2" plywood
- PolyFlex™ one piece underbelly covering
- Seamless rubber roof with 12 year warranty
- TuffShell™ vacuum-bond laminated sidewalls
- Welded tubular-aluminum sidewall framework
- 81" living room ceiling height
- Heated & enclosed fresh water tank & holding tanks
- Roof Rafters, constructed of residential style tapered 4 1/2" trusses

Standard Safety Equipment

- Break away switch
- Carbon monoxide detector
- Dead bolt lock on entrance door
- Fire extinguisher
- LP gas detector
- Multiple egress windows
- Smoke detector
- Tinted safety glass windows
- Dual hitch safety chains

Optional Features

- Spare tire and tire carrier with vinyl tire cover
- CD Stereo in Bunk
- Ceiling Fan
- CSA standards
- Double Bunk Beds
- Holding tank sprayer
- Linoleum in living area
- Outside portable gas BBQ grill with carrying case
- Thermal Pane Tinted Safety Glass Windows
- Extendable Dinette
- Oak free standing table with 4 chairs
- Black holding tank sprayer
- Ladder to roof
- Swivel rocker
- Sofa

Customer Value Package

- 6 gallon gas/electric DSI auto-ignition water heater
- Carefree® patio awning
- Central A/C, 15,000 BTU
- Deluxe pillow-top mattress
- Dolby® Digital 5.1 Surround Sound Home theater system w/DVD
- Extra insulation in roof
- Floor mounted safe
- Foldable, exterior grab handle
- Microwave oven with carousel
- Powered attic fan in bathroom
- Security lights (2)
- Skylight in tub/shower
- Water purification system

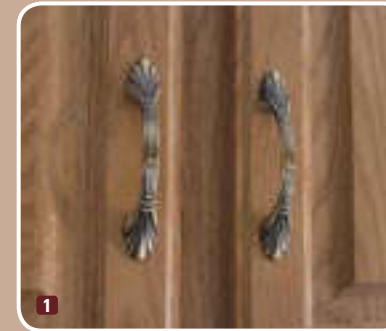

1. Antique Brass Hardware

Our antique brass drawer and cabinet pulls add an elegant touch to the décor.

2. Crown Molding

Crown molding gives the Eagle the distinctive feel of a luxury home.

3. Fairfield Oak

Eagle travel trailers and fifth wheels feature solid Fairfield Oak cabinet doors.

4. Raises Panel Cabinet Doors

Raised panel cabinet drawers and doors add traditional, home-style appeal.

Interior color option

Interior color option

Interior color option

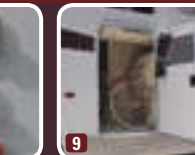
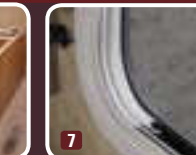

QUALITY IS STANDARD EQUIPMENT



FLOORPLANS

2006 EAGLE by Jayco®

2006 Travel Trailer Floorplans

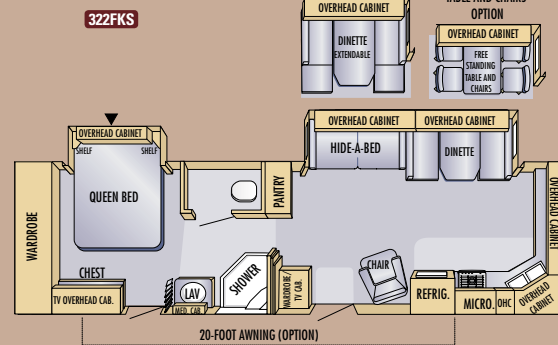
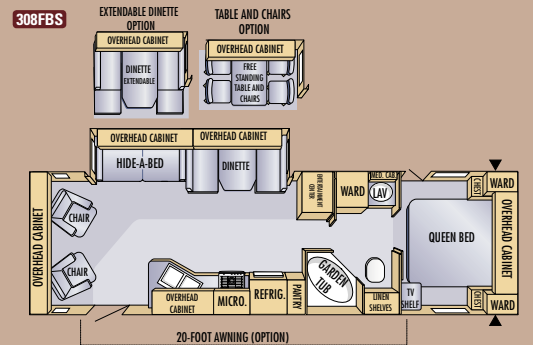
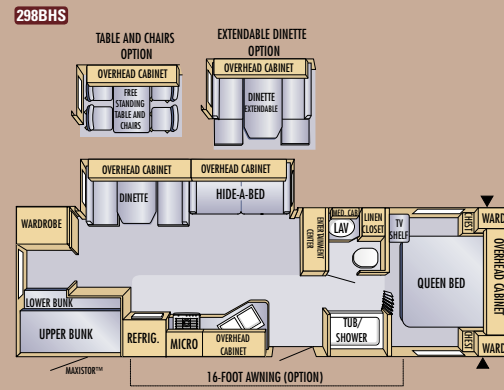
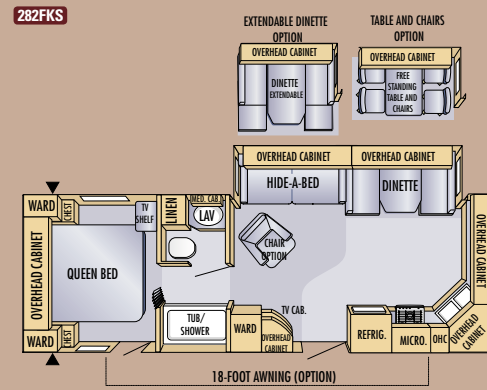
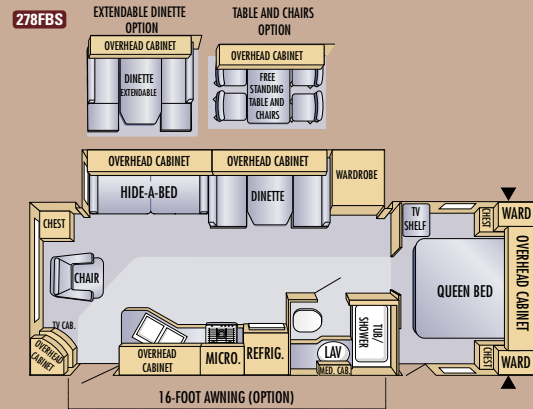

LEGEND

- = Carpeted Areas
- ▲ = Outside Storage Compartments
- LAV. = Bathroom Sink
- MICRO. = Microwave
- OHC = Overhead Cabinets
- REFRIG. = Refrigerator
- WARD. = Wardrobe

For the latest in the most liveable floorplans available, visit www.jayco.com

Travel Trailer Specifications

Models	Exterior Length	Exterior Height	Bedroom Interior Height	Unloaded Vehicle Weight	Dry Hitch Weight	Gross Vehicle Weight Rating	Cargo Carrying Capacity	Fresh Water Capacity	Gray Wastewater Capacity	Toilet/Black Wastewater Capacity
298 BHS	32.5'	134"	81"	7415	1015	9500	2085	46.2	37	37
308 BHS	33.3'	134"	81"	7375	745	9500	2125	46.2	37	37
282 FKS	29.66'	134"	81"	6870	1125	8500	1630	46.2	37	37
278 FBS	29.28'	134"	81"	6885	900	9000	2115	46.2	37	37
322 FKS	33.92'	134"	81"	7965	1265	10250	2285	46.2	48.5	48.5
280 FSS	29.66'	135"	81"	6615	995	8500	1885	46.2	37	37

To find out more about America's Most Liveable RVs, visit www.jayco.com

2006 Fifth Wheel Floorplans

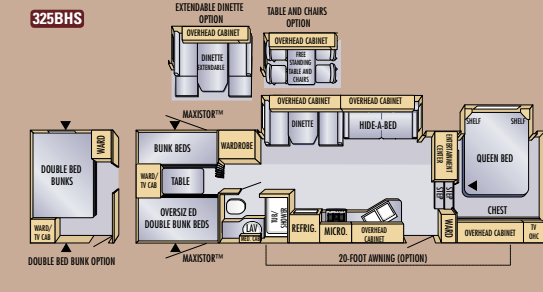
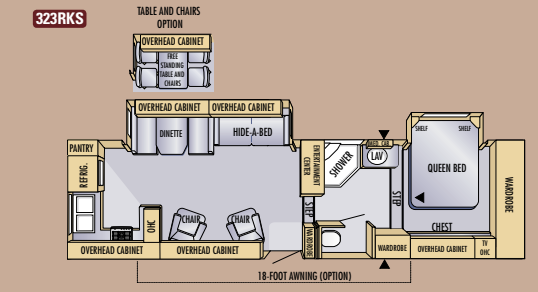
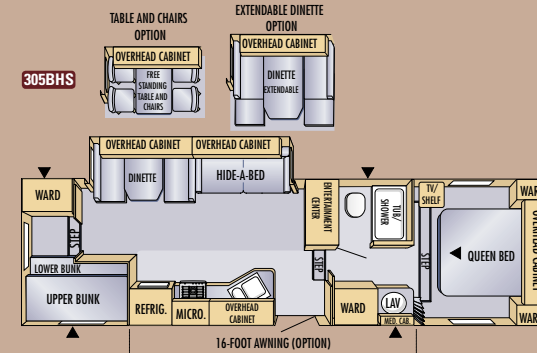
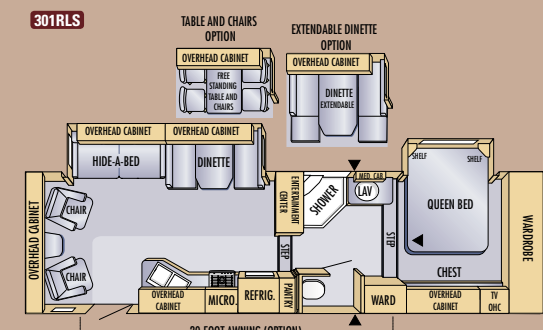
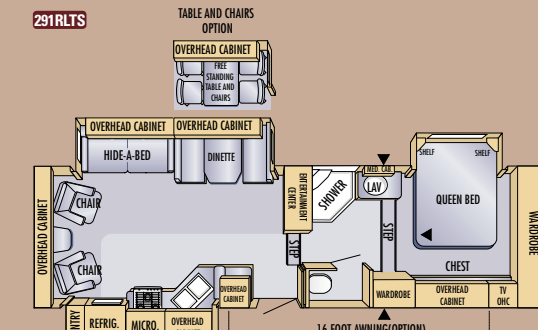
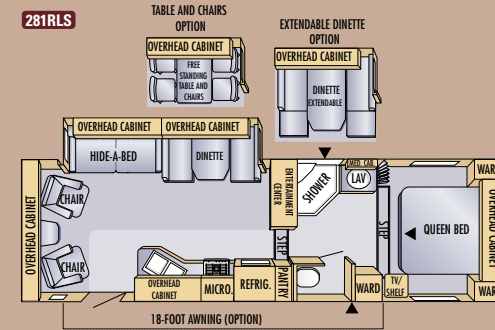

Fifth Wheel Specifications

Models	Exterior Length	Exterior Height	Bedroom Interior Height	Unloaded Vehicle Weight	Dry Hitch Weight	Gross Vehicle Weight Rating	Cargo Carrying Capacity	Fresh Water Capacity*	Gray Wastewater Capacity	Toilet/Black Wastewater Capacity
281 RLS	30.4'	138"	77"	7,845	1645	10,500	2655	46.2	37	37
305 BHS	32.4'	138"	77"	8,355	1400	10,500	2145	46.2	37	37
291 RLTS	33.3'	148"	87"	9,595	2,160	12,500	2905	46.2	37	37
301 RLS	33.3'	148"	87"	8,995	2130	12,000	3005	46.2	37	37
325 BHS	35.3'	146.25"	72"	9,535	1,915	12,500	2965	46.2	45	45
323 RKS	34.2'	148"	72"	9,195	2,055	12,000	2805	46.2	37	37

It is important for your safety and enjoyment that your tow vehicle be adequately sized and equipped to tow and handle the GVWR of the RV you select. Review weights and rating of your tow vehicle and consult a competent advisor for questions or advice. Whether you are new to RVing or a veteran, get a feel for the performance of your tow vehicle and the RV together before heading out on the road. When you tow an RV, you must drive differently than you do when driving a single vehicle. Practice hooking up, driving, backing up, and braking in a safe environment or seek out professional instruction. Jayco affixes a weight label to each RV which lists weight information for that vehicle. **See specification chart above.**

Unloaded Vehicle Weight (UVW): Sometimes referred to as "Dry Weight," UVW means the typical weight of this trailer as built at the factory. The UVW, as used in product literature and other promotional materials, does not include cargo, fresh water, LP gas, options, or dealer-installed accessories.

Gross Vehicle Weight Rating (GVWR): GVWR means the maximum permissible weight of the trailer, including the UVW plus passengers, personal items, all cargo, fluids, options, and dealer-installed accessories. The GVWR is equal to or greater than the sum of the UVW and the CCC.

*Includes water heater capacity

Cargo Carrying Capacity (CCC): CCC means the maximum weight of all passengers, personal items, food, fresh water, LP gas, tools, other cargo, and dealer-installed accessories that can be carried by the trailer. CCC is equal to or less than GVWR minus UVW. The addition of options will decrease the CCC.

Hitch Weight (HW): The hitch weight, as used in product literature and other promotional materials, does not include cargo, fresh water, propane gas, options or dealer-installed accessories. The addition of these types of items will either add to or subtract from the stated hitch weight.

Customer First Roadside Assistance

Travel worry-free in your Eagle recreational vehicle with Jayco's Customer First Roadside Assistance program, yours at no cost during your first year of ownership. This program is offered through Coach-Net®, the largest RV emergency road service in the country, and gives you immediate access to dependable roadside assistance and support services with a simple phone call.

Emergency Roadside Assistance

- Free jump starts
- Free tire changes
- Free fuel delivery
- Free lockout service
- Free travelers checks
- \$500 trip interruption reimbursement
- 24-hour toll-free emergency message service
- Toll-free nationwide service appointment assistance
- Free custom trip routing and full color map service
- Free dispatch of on-site mechanical service
- \$1,000 auto theft or hit-and-run reward



We Back What We Build.

The Jayco Co-Pilot Warranty is a manufacturer's limited warranty. It doesn't come from your dealer and it's not an extended warranty! It comes from the people who build Jayco recreation vehicles to the people who buy them. Each Jayco is warranted to the original purchaser for twenty-four (24) months or twenty-four thousand (24,000) miles (mileage limitation applies to motorized products only), whichever occurs first, from the original date of purchase against defects in materials and workmanship. In addition, our limited warranty may be transferred one time within the warranty period. Go ahead and compare the Jayco warranty with other manufacturers' warranties. You'll find it's the best in the business!

For a copy of the limited warranty with full terms and conditions, ask your local Jayco dealer or visit our website at www.jayco.com.

Your Jayco Dealer

See above dealer for further information and prices.

As a Jayco owner, you can be part of the Jayco Jafari International Travel Club. Ask your dealer about the Jafari "flight" in your area, write Jayco, or visit our web site.



Please Note: All information in this brochure is the latest available at the time of publication approval. Jayco reserves the right to make changes and to discontinue models without notice or obligation. Photos in this brochure may show optional equipment. RVs built for sale in Canada may differ to conform to Canadian codes.



©2006 Jayco, Inc. 06-EAGL-PL 0705-100K Printed in U.S.A.

RVQ is a registered trademark of Vitco, Inc. E-Z Lube is a registered trademark of the Dexter Axle Company. Carefree is a registered trademark of Carefree of Colorado. Dolby and the double-D symbol are registered trademarks of Dolby Laboratories.



AMERICA'S MOST LIVEABLE RVs.